

ENGLISH

**MC37,40
INSTRUCTION MANUAL**

CONTENTS

I . SPECIFICATIONS AND FEATURES	1
II . INSTALLATION AND OPERATION OF COMPONENTS.....	2
1. Installing the connecting rod MC40.....	2
2.Adjusting the connecting rod air valve MC40.....	2
3.Assembling the cloth chip and chain-off thread suction device	3
4.Connecting the flexible hose.....	3
5.Adjusting the suction force	4
6.Installing the waste bag	4
7.Piping the air components.....	5
III . INSTALLING PROCEDURE OF THE EXCLUSIVE CORD FOR MF (INSTALLING SC-921)	6



CAUTION

This Instruction Manual is intended for the MC37,MC40 To use this product when it is installed on a machine (sewing machine), make sure to read and fully understand the “IMPORTANT SAFETY INSTRUCTIONS” provided in the Instruction Manual for the machine on which this product is to be installed in advance.

For a clearer view of the MC37,MC40 illustrations of the machine (sewing machine) are simplified, and illustrations of some of the safety devices are partially omitted.

PREFACE

Congratulations on your purchase of the JUKI MC37 and MC40 cloth chip suction devices for the MF-7900-H22,23 and MF-7900-E11.

The devices are used to pneumatically collect cloth chips by depressing the motor pedal.

We wish the devices help achieve clean working environment in your factory.

I . SPECIFICATIONS AND FEATURES

Model	MC37	MC40
Name	Pneumatic cloth chip suction device with a solenoid valve	Pneumatic cloth chip suction device with a pedal connecting rod air switch
Applicable machines	MF-7900-H22,23 and MF-7900-E11 provided with the control box (SC-921)	MF-7900-H22,23 and MF-7900-E11
Major features	<ul style="list-style-type: none">• At the moment when the pedal is depressed, the device is pneumatically actuated to suck up cloth chips.• It is possible to dump thread waste or cloth chips with ease since the cloth chip suction portion is the bag type.	<ul style="list-style-type: none">• At the moment when the pedal is depressed, the device is pneumatically actuated to suck up cloth chips.• It is possible to dump thread waste or cloth chips with ease since the cloth chip suction portion is the bag type.

II. INSTALLATION AND OPERATION OF COMPONENTS

1. Installing the connecting rod MC40

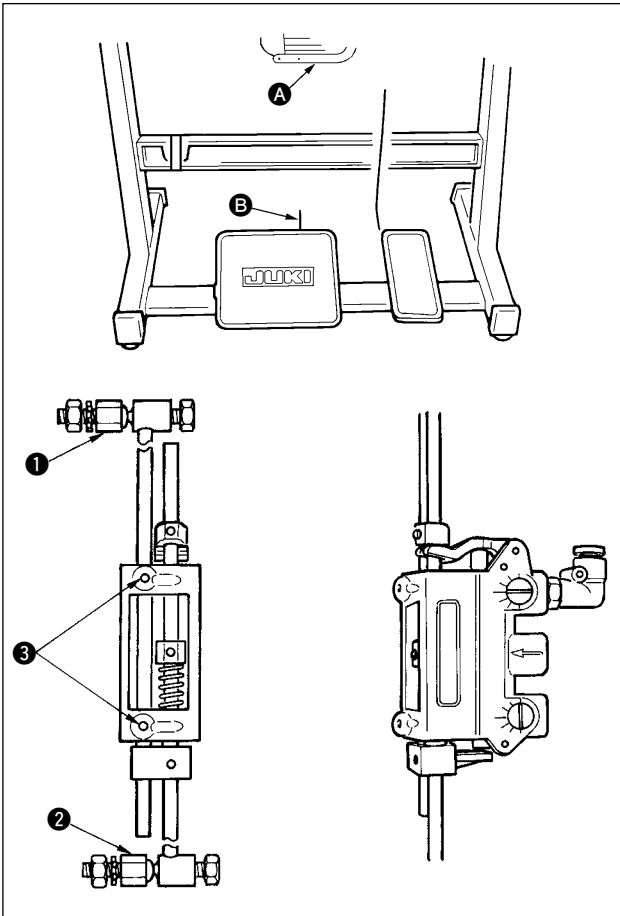

Taking care of the vertical direction of the connecting rod, fix the top end of the rod on motor lever **A** using the screw of ball joint **1**, and fix the bottom end of the rod on pedal lever **B** using the screw of ball joint **2**. Loosen fixing screws **3** in the connecting rod, and adjust the length of the rod properly.

2. Adjusting the connecting rod air valve MC40

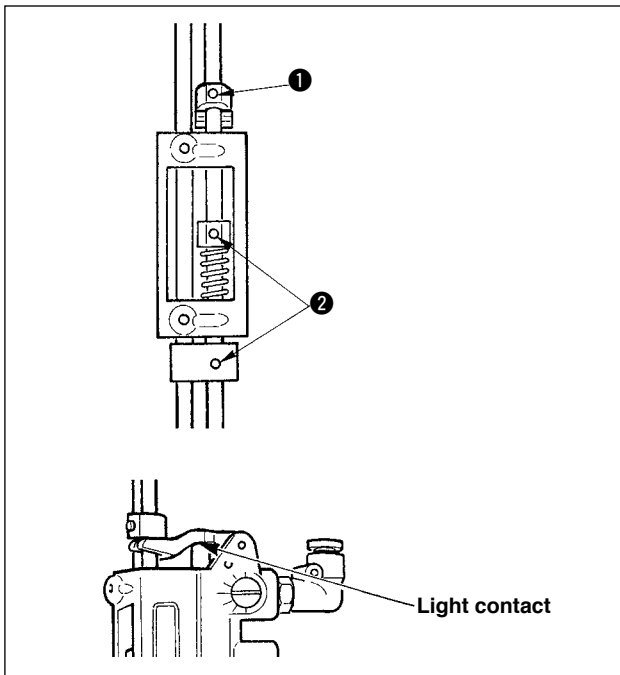

- 1) Loosen setscrew **1** in the valve holder, and adjust the position of air valve properly. The standard position of the air valve is obtained when the valve pin lightly comes in contact with the head of rivet.
- 2) Make the sewing machine actuate, and check the response time of the air valve. If it is too early, separate the valve pin from the rivet head, and adjust the response time properly.
- 3) Once the air valve is properly positioned, securely tighten setscrew **1** in the valve holder. At this time, check the position of thrust collar **2** so as to eliminate a play in the spring.

3. Assembling the cloth chip and chain-off thread suction device

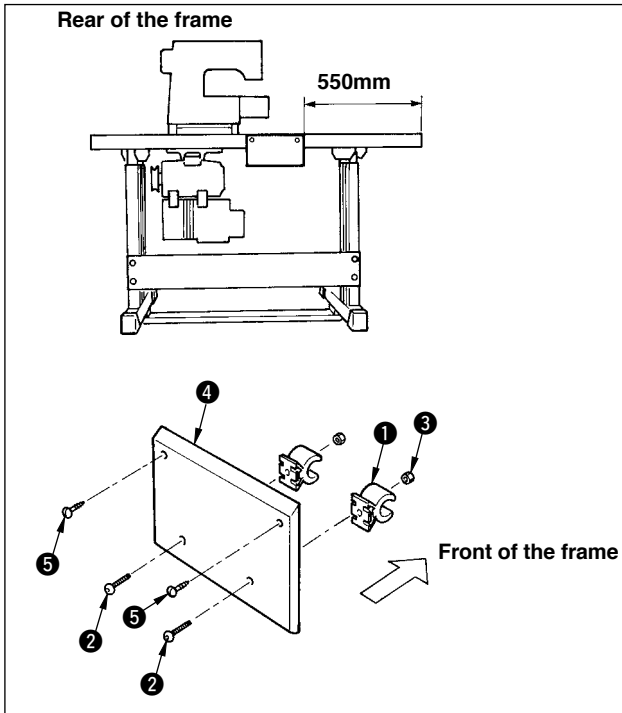

- 1) Fix two tube clips ① to mounting plate ④ with screws ② and fitting lock nuts ③.
- 2) Fix mounting plate ④ with (tube clip) installing wood screws ⑤ so that tube clips ① face the operator's side at the bottom face of the table while satisfying the dimensions of the table shown in the figure.

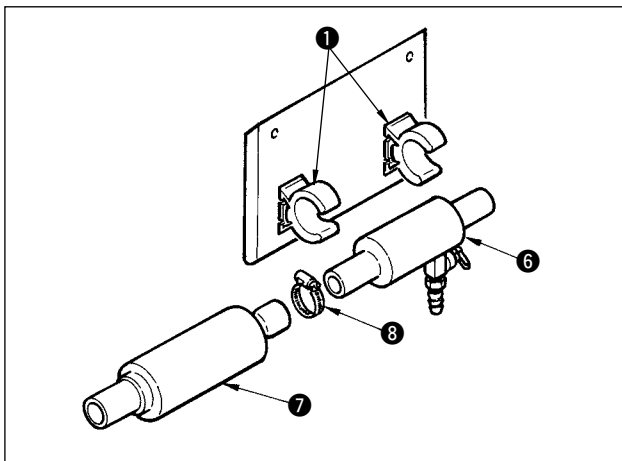

- 3) Fit waste remover body ⑥ to tube clips ① which have been fixed in step 2), fit muffer ⑦ and hose clamp ⑧ to waste remover body ⑥, and tighten it with hose clamp ⑧.

4. Connecting the flexible hose

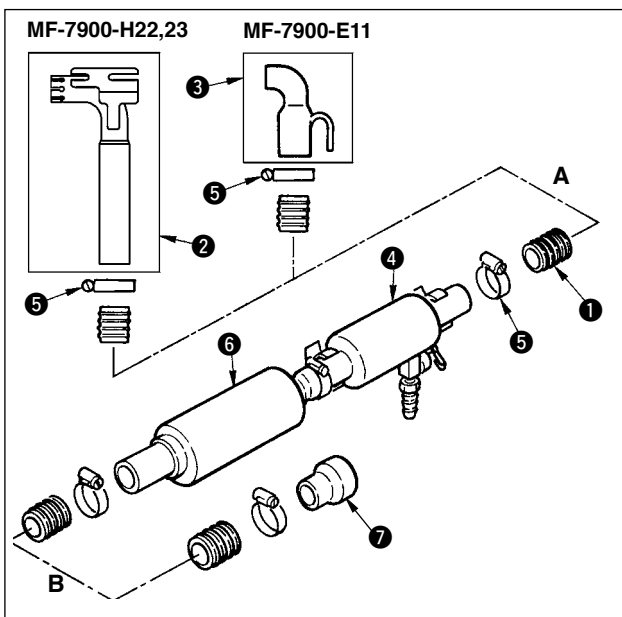

- 1) Cut flexible hose ① to a length required for connection on side A. In case of MF-7900-H22,23, attach it to cloth chip pipe (asm.) ② and waste remover body ④. In case of MF-7900-E11, attach it to pipe (asm.) ③ and waste remover body ④, and clamp each with hose clamp ⑤. At this time, take care not to allow the flexible hose to excessively slacken.
- 2) Then connect muffer ⑥ on side B and reducing socket ⑦. At this time, also cut the hose to an appropriate length. After connecting the tube to them, clamp them with hose clamp ⑤.



The flexible hose is slightly too long to provide a margin, however, cloth chips may remain in the middle of the hose if the hose slackens excessively. So, do not make the hose longer than is necessary or slacken it excessively.

5. Adjusting the suction force

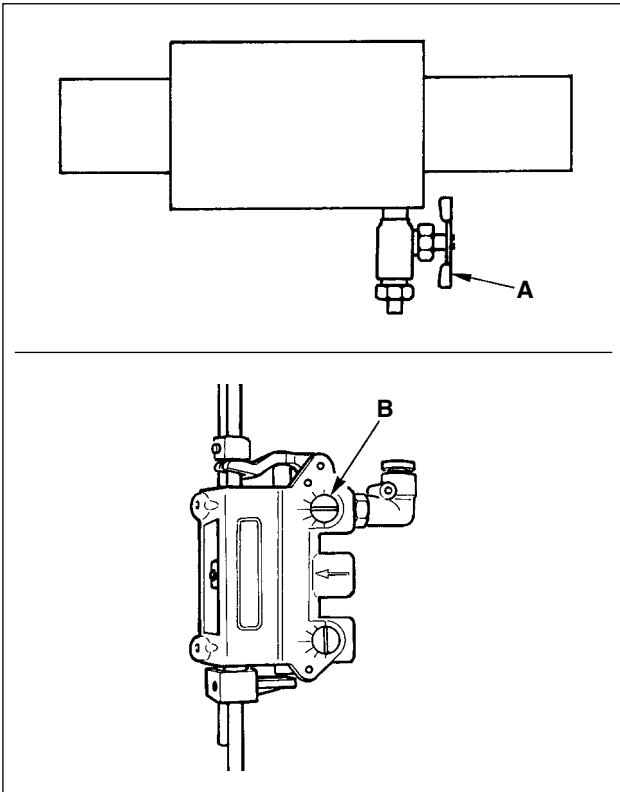

When **A** is turned clockwise, the suction force is decreased. For the mechanical valve of MC37, the suction force can be adjusted by turning **B** with a screwdriver or the like.

6. Installing the waste bag

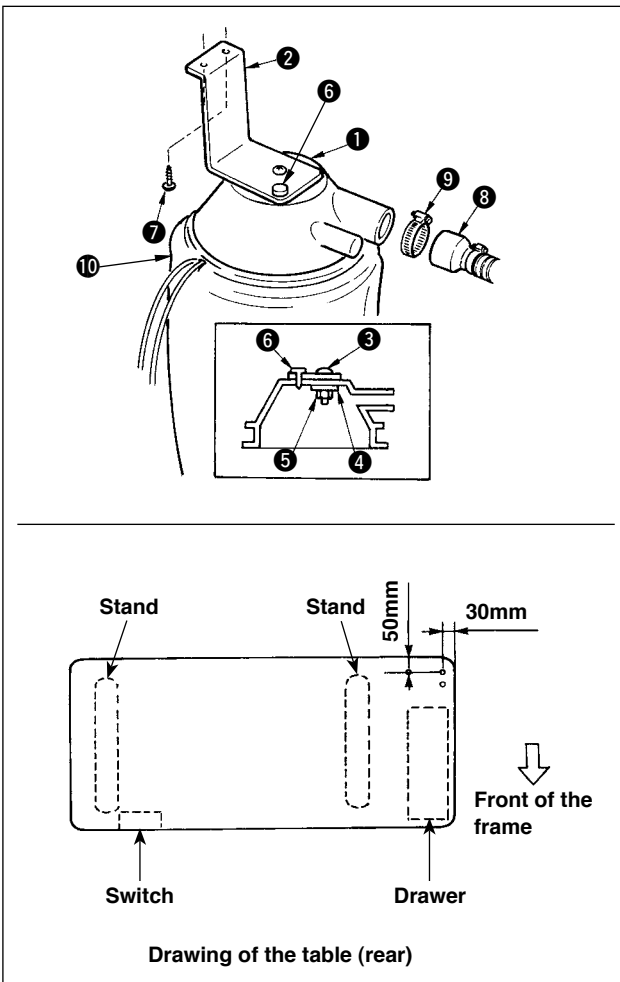

- 1) Install waste bag plate **2** to waste bag housing **1** with screw **3**, washer **4** and nut **5**. In this state, however, plate **2** rotates. To stop the state, insert stop plug **6** into the hole of waste bag housing **1** and waste bag plate **2** so that plate **2** faces the direction as shown in the figure.
- 2) Fix waste bag plate **2** to the position as shown in the figure with wood screws **7**.
- 3) Insert reducing socket **8** into the cloth chip inlet port of waste bag housing **1**, and clamp it with hose clamp **9**.
- 4) Install the mouth of waste bag **10** so as to run parallel with the groove of waste bag housing **1**, and clamp it with a piece of string.

7. Piping the air components

Fix solenoid valve ③ under the table with wood screws supplied as accessories.
Refer to the piping diagram shown for piping the air components.

 **The air tube is slightly too long.
Cut it to an appropriate length before connecting it.**

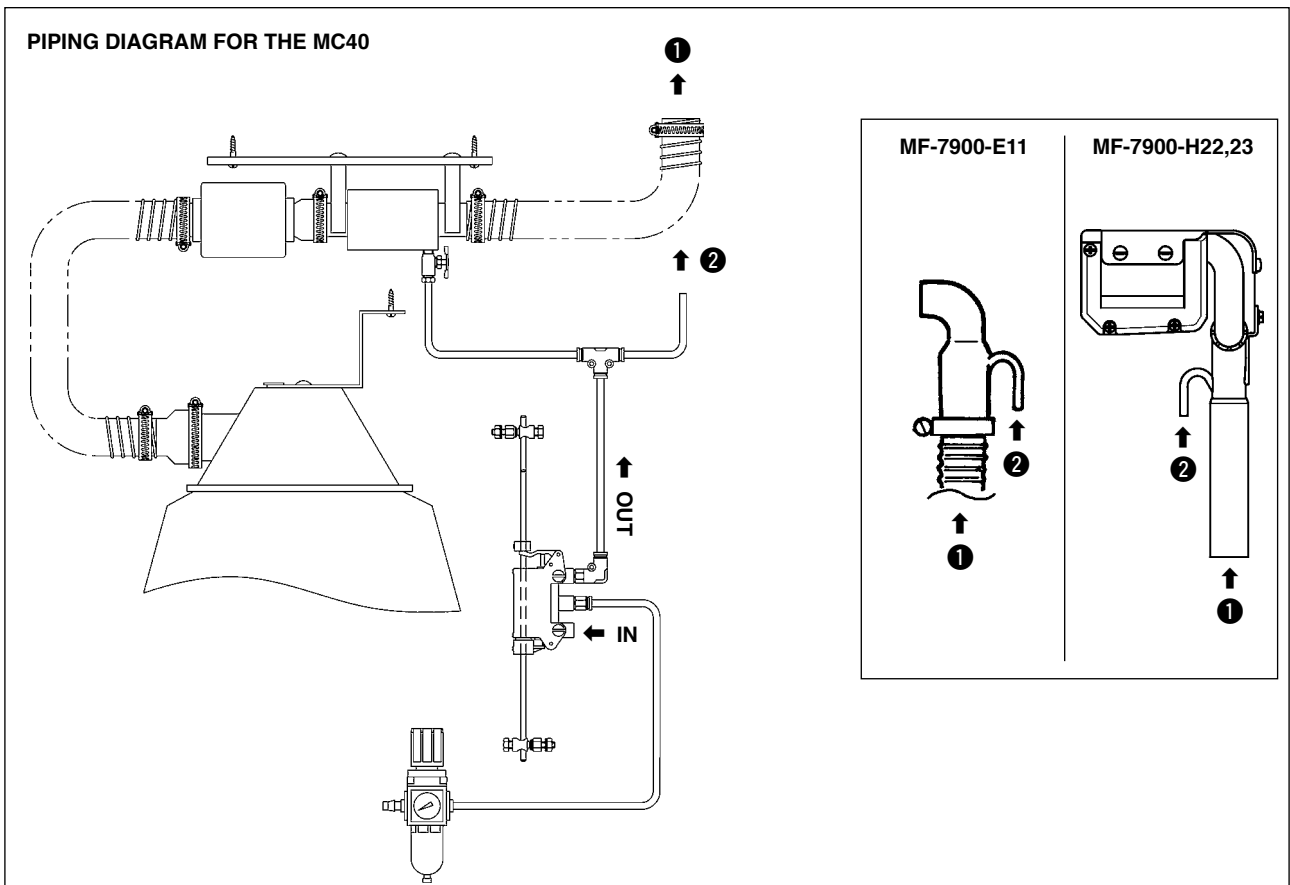
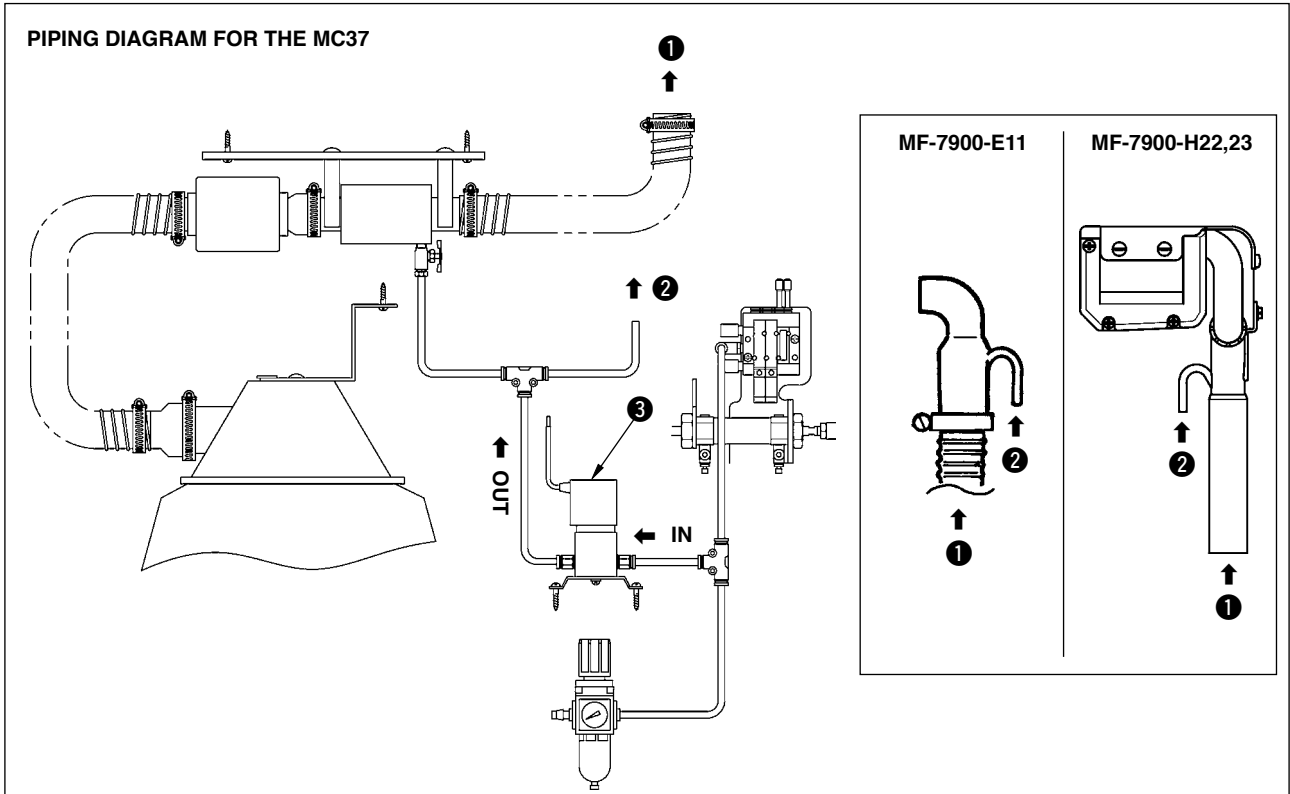

III. INSTALLING PROCEDURE OF THE EXCLUSIVE CORD FOR MF (INSTALLING SC-921)

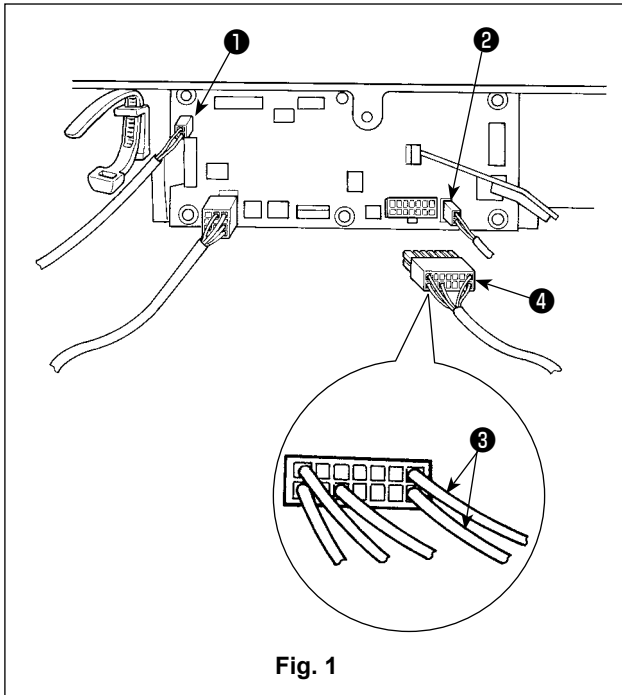

Connect the exclusive cords for MF to the respective specified connectors.

- Thread trimmer sensor cord ① → CN42
- Presser lifter cord ② → CN37
- Connect solenoid valve cords ③ of MC to connector 36.
(Connecting No. : No. 14 → White and No. 7 → black)
- Solenoid valve cord of MC and thread trimmer cord ④
→ CN36

Fig. 1 shows the connection of connector of UT57 and MC37 as an example. When depressing the motor pedal after completing the connection of connector of MC, a signal appears, and it is not necessary to set the panel. In addition, refer to (III-3. Installing and setting of SC-921) of the Instruction Manual for MF-7900(D)/UT55,56,57 when MC37 does not start.

