

ENGLISH

**MD11
INSTRUCTION MANUAL**

CONTENTS

| | |
|--|---|
| 1. MD11 (TAPE FEED DEVICE) | 1 |
| 2. SAFETY DEVICE | 1 |
| 3. SPECIFICATIONS..... | 1 |
| 4. INSTALLING PROCEDURE OF THE ACCESSORIES | 2 |
| 5. LUBRICATING PROCEDURE | 3 |
| 6. ADJUSTMENT OF THE ROUTE OF ELASTIC TAPE..... | 4 |
| 7. ADJUSTING PROCEDURE OF THE TAPE FEED AMOUNT | 5 |
| 8. INSTALLING POSITION OF THE ECCENTRIC CAM..... | 6 |
| 9. FOLLOWER ROLLER RELEASE LOCK..... | 7 |
| 10. REMOVING THE TAPE GUIDE SECTION | 8 |

1. MD11 (TAPE FEED DEVICE)

This device is the device that is used for attaching elastic tape (elastic lace). This device supplies the machine with tapes of equal length, synchronizing the feed, and provides the sewing products of a fine finish. Elastic tape (elastic lace) up to max. 45 mm in width can be used, and be supplied within the range of 0.9 to 3.5 mm per stitch.

2. SAFETY DEVICE

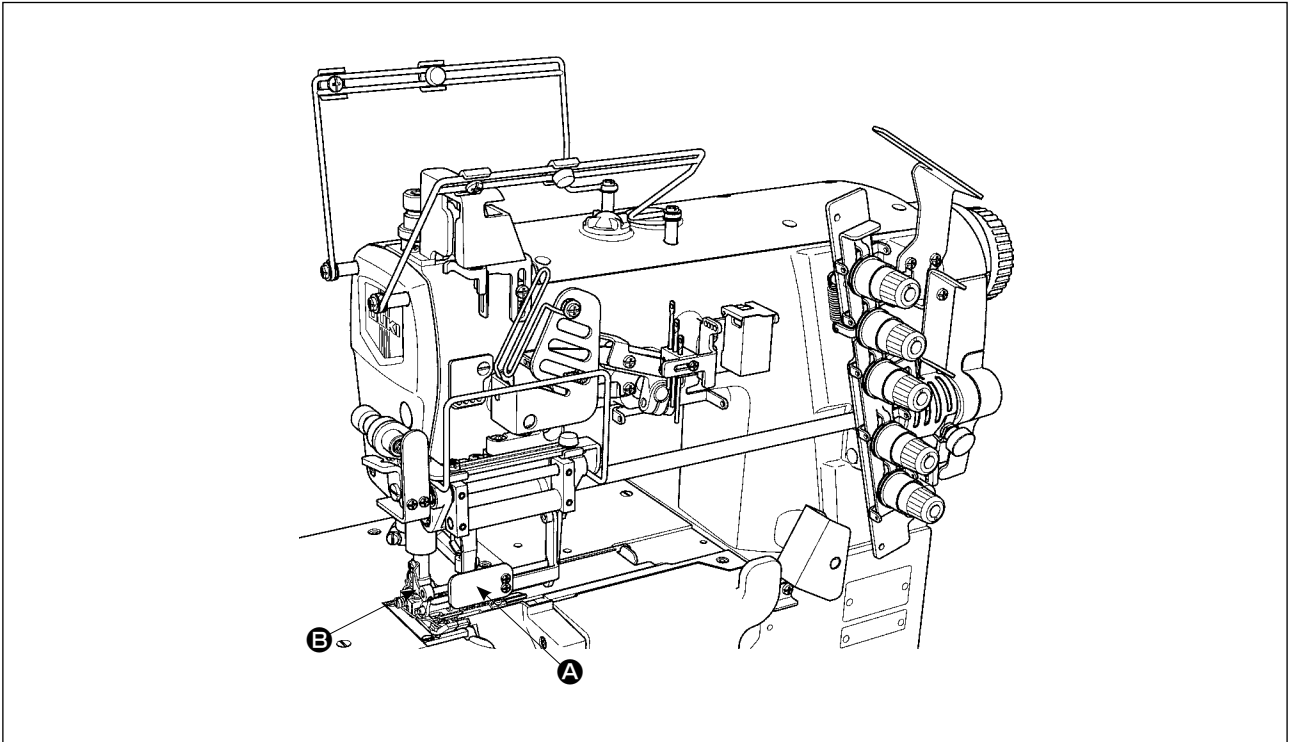

- Ⓐ Eye protection cover : Cover to protect eyes from being injured by needle breakage
- Ⓑ Finger guard : Cover to protect fingers from coming in contact with needles

3. SPECIFICATIONS

| | | |
|------------------|----------|--|
| Model | | MD11 |
| Class name | | Mechanical metering device |
| Sewing speed | | Max. 5,000 sti/min (at the time of intermittent operation) Speed of stitch at the delivery. 4,000 sti/min (at the time of intermittent operation) |
| Needle gauge | 3-needle | 5.6 mm, 6.4 mm |
| | 2-needle | 4.0 mm |
| Tape width | | 45 mm |
| Tape feed amount | | 0.9 to 3.5 mm |
| Noise | | - Equivalent continuous emission sound pressure level (L_{pA}) at the workstation : A-weighted value of 76.5 dB; (Includes $K_{pA} = 2.5$ dB); according to ISO 10821- C.6.2 -ISO 11204 GR2 at 4,000 sti/min. |

4. INSTALLING PROCEDURE OF THE ACCESSORIES

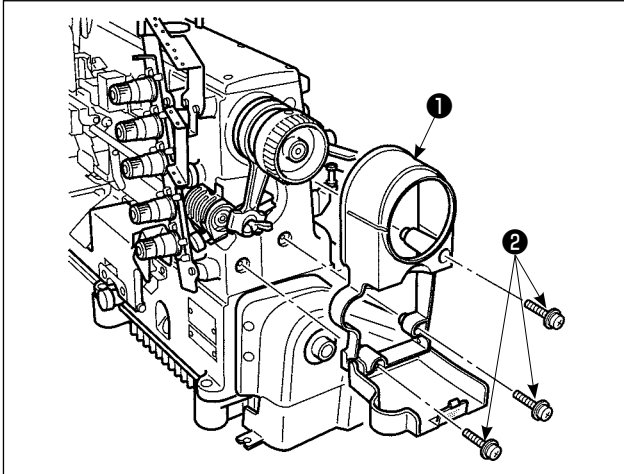

(1) Installing the pulley cover

Install pulley cover **1** on the frame at three places with screws **2** with pulley cover **1** opened.



After installing the pulley cover, confirm that it does not interfere with other components.

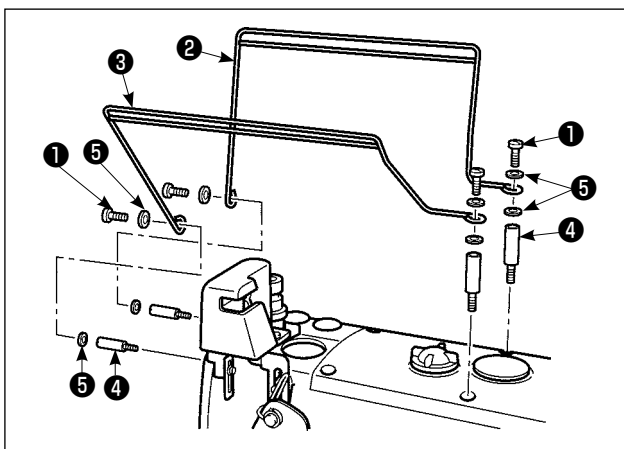

(2) Installing the support guide

- 1) Remove four screws **1**.
- 2) Attach studs **4** to the place where screws **1** have been removed.
- 3) Put support guide **2** between washers **5** and fix it to stud **4** with screw **1**.
- 4) Fix support guide **3** with the same procedure as above 3).

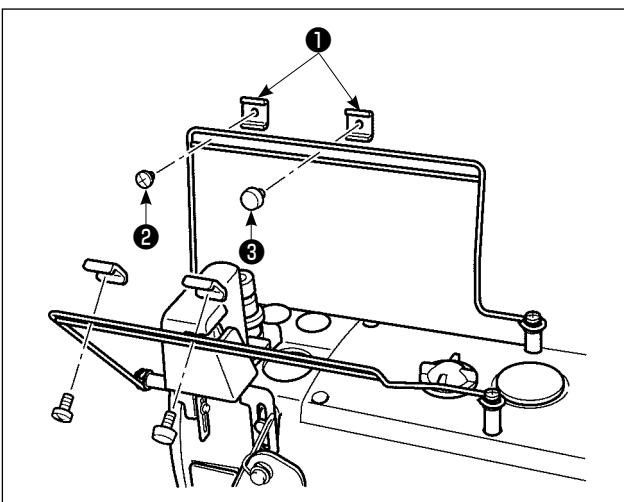

(3) Installing the side guide

Attach two side guides **1** respectively to two support guides which have been attached in step **"4-(2) Installing the support guide"** p.2.

Fix the side guide on the left-hand side with screws **2** and the side guide on the right-hand side with thumbscrews **3** respectively.



For adjusting the installing position of the side guide width, refer to **"6-(2) Adjusting the side guide according to the elastic tape width"** p.4.

5. LUBRICATING PROCEDURE

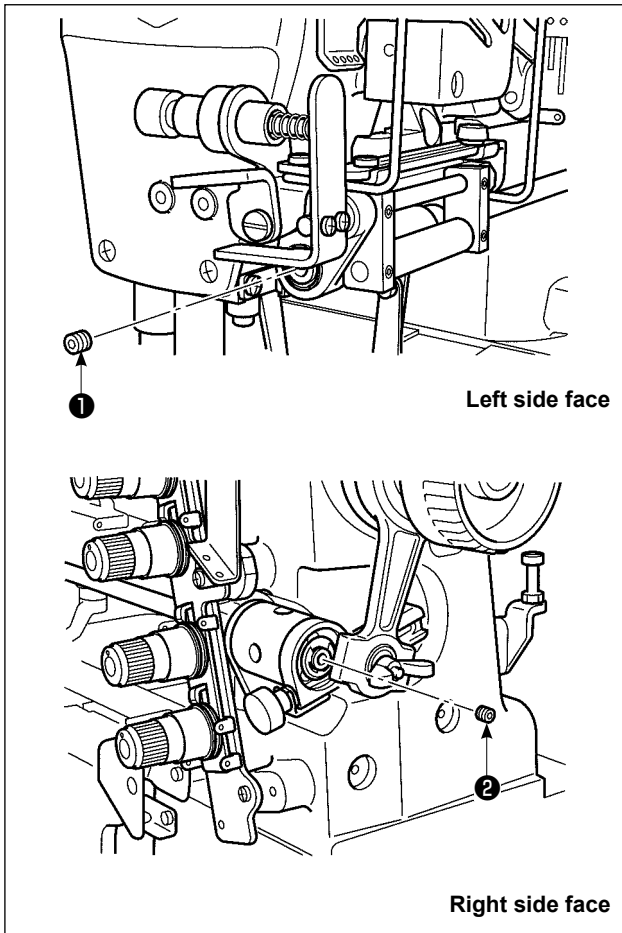

(1) Lubrication to the bearing

- Grease has been applied to the bearing at the time of delivery from the factory.

- 1) Remove screws ① and ② from the both ends of the shaft and fully apply grease supplied as accessories.
- 2) After applying grease, attach screws ① and ② to the both ends of the shaft.

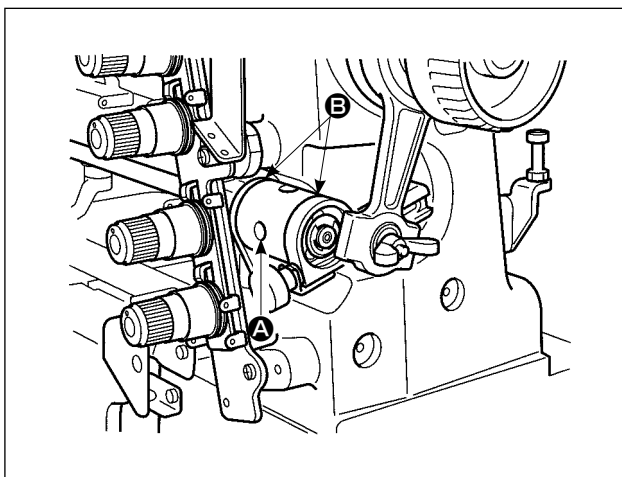

(2) Lubrication to the clutch

- Grease has been applied to the clutch at the time of delivery from the factory.

- 1) Remove the screw from section ① of the clutch.
- 2) Apply grease supplied as accessories from section ①. At this time, apply grease until new grease comes out from sections ②.
- 3) After filling the grease, put the screw back in section ① and tighten it.



For the lubrication to the clutch, apply grease at 100 hours of the operation as a standard. There is the possibility that excessive grease leaks from sections ② of the clutch at the time of delivery or of using after lubrication. When grease leaks out, wipe it.

JUKI Part No. of exclusive grease :
13525506

6. ADJUSTMENT OF THE ROUTE OF ELASTIC TAPE

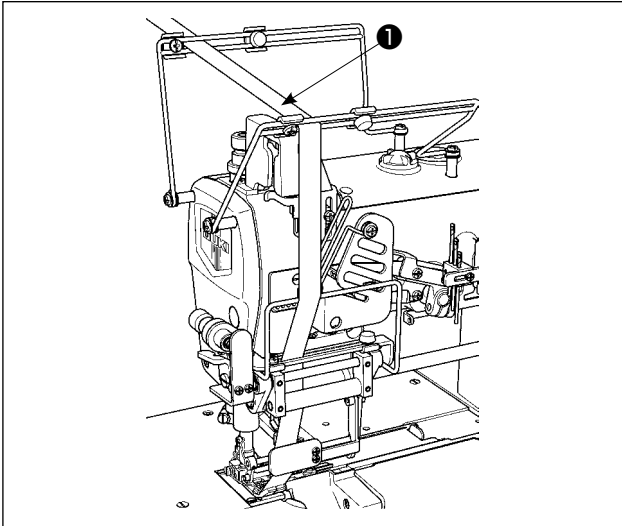

(1) Supply route of the elastic tape

Pass elastic tape ① through the route after releasing the follower roller.

(Refer to "9. FOLLOWER ROLLER RELEASE LOCK" p.7.)

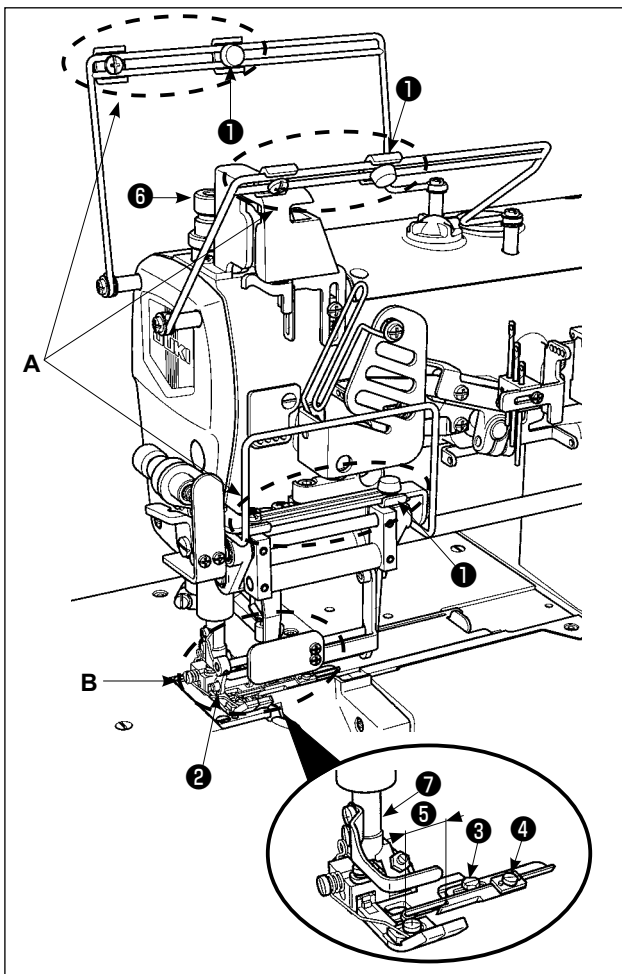

(2) Adjusting the side guide according to the elastic tape width

Adjust the positions of side guides A ① at sections A (three places), side guide B ② at section B and guide width ⑤ of the presser at section B according to the width of elastic tape to be used. For guide width ⑤ of the presser at section B, loosen screws ③ and ④ and carry out adjustment.

(3) Removing /Attaching procedure of the presser

To remove or attach the presser, loosen presser spring regulator ⑥ and lower collar ⑦ .

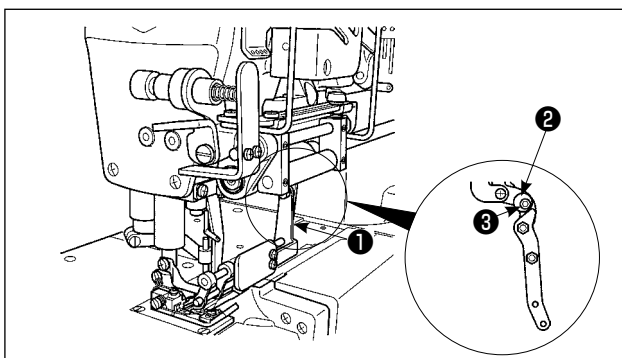

(4) Adjusting the position of the tape guide

For the adjustment between tape guide ① and the presser, loosen screw ③ , and turn stopper ② to adjust. After the adjustment, fix it with screw ③ .

7. ADJUSTING PROCEDURE OF THE TAPE FEED AMOUNT



WARNING :

To protect against possible personal injury due to abrupt start of the machine, be sure to start the following work after turning the power off and ascertaining that the motor is at rest.

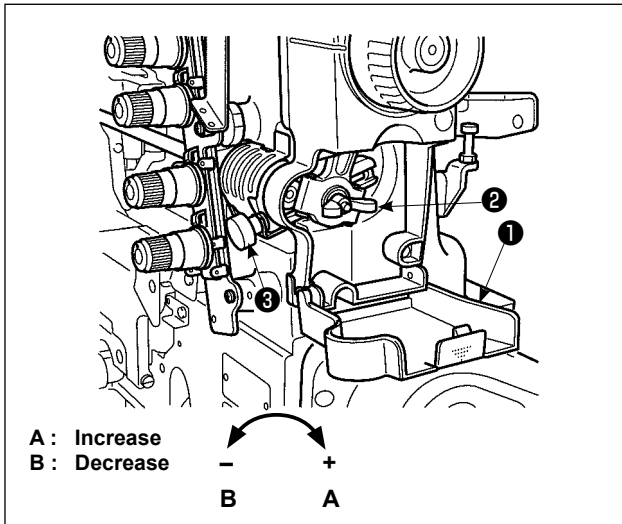

(1) Adjusting the feed amount with the thumbscrew

Tape feed amount can be adjusted by adjusting the thumbscrew. Fine adjustment is performed in step "7-(2) Adjusting the spring pressure" p.5. Tape feed amount can be adjusted within the range of 0.9 to 2.2 mm with this adjustment.

* When using the tape feed amount between 1.4 to 3.5 mm, refer to step (3).

1) Open pulley cover ①, and loosen butterfly nut ②.

2) Turn knob ③, and adjust the feed amount.

* Turn knob ③ clockwise (+ direction) to increase the feed amount. Turn it counterclockwise (- direction) to decrease the feed amount.

3) After tightening butterfly nut ②, close pulley cover ①.

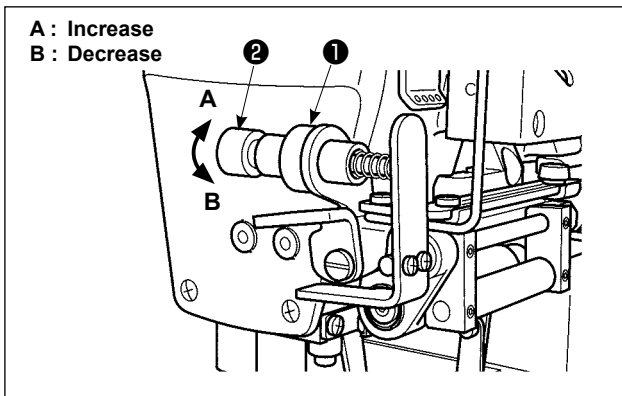

(2) Adjusting the spring pressure

Fine adjustment of the feed amount can be performed by adjusting the spring pressure.

1) Loosen nut ①.

2) Turn adjustment screw ② to adjust the spring pressure.

* When the spring pressure is increased, the tape feed amount is decreased.

When the spring pressure is decreased, the tape feed amount is increased.

3) Tighten nut ①.

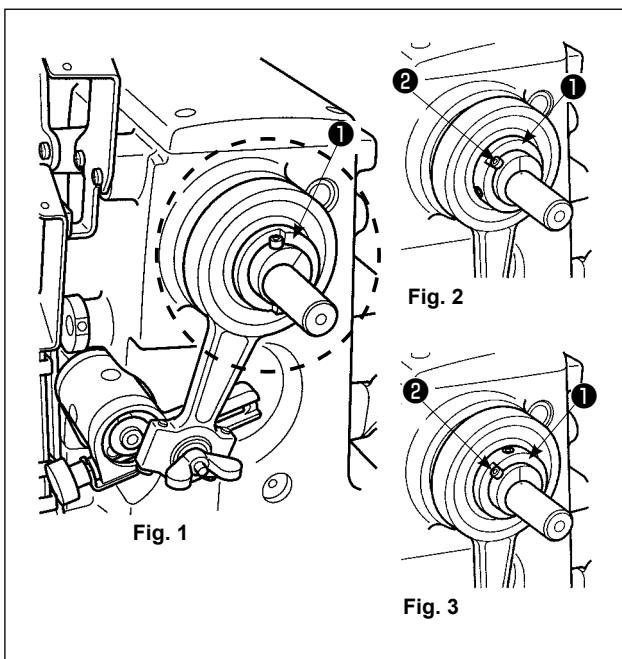

(3) Adjusting the feed amount with the cam

Tape feed amount can be changed from 0.9 to 2.2 mm (at the time of delivery from the factory) to the range of 1.4 to 3.5 mm by adjusting eccentric cam B ①.

1) Remove the pulley cover and the pulley.

(Refer to Fig. 1.)

2) Loosen two screws in eccentric cam B ①.

3) [When the tape feed amount is 0.9 to 2.2]

(Refer to Fig. 2.)

Tighten and fix two screws in eccentric cam B ① at the position where the notch of eccentric cam B ① comes in contact with the left-hand side of screw ②.

[When the tape feed amount is 1.4 to 3.5]

(Refer to Fig. 3.)

Tighten and fix the screw in eccentric cam B ① at the position where the notch of eccentric cam B ① comes in contact with the right-hand side of screw ②.



For the matters that demand special attention to the fixed position of the eccentric cam, refer to "8. INSTALLING POSITION OF THE ECCENTRIC CAM" p.6.

8. INSTALLING POSITION OF THE ECCENTRIC CAM



WARNING :

To protect against possible personal injury due to abrupt start of the machine, be sure to start the following work after turning the power off and ascertaining that the motor is at rest.

Fig. 4

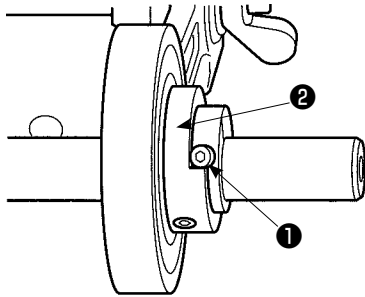

Fig. 3

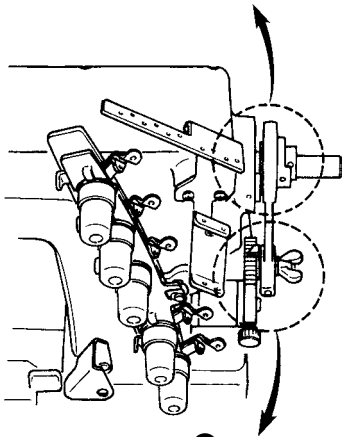
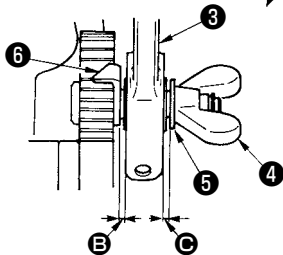

Fig. 5



(2) Installing position of the eccentric cam

When performing adjustment of "7-(3) Adjusting the feed amount with the cam" p.5, be careful of the points below for the installing position of eccentric cam B ② .

- 1) Press eccentric cam B ② against screw ① of eccentric cam A as illustrated in Fig. 4.
- 2) Tighten two screws each ⑦ and ⑧ of eccentric cams A ① and B ② so that clearances ② and ③ between washer ⑤ , pointer ⑥ and rod ③ are equal in the state that butterfly nut ④ is tightened as shown in Fig. 5.



After the adjustment, turn the pulley by hand to check that the cams move without interference.

9. FOLLOWER ROLLER RELEASE LOCK



WARNING :

To protect against possible personal injury due to abrupt start of the machine, be sure to start the following work after turning the power off and ascertaining that the motor is at rest.

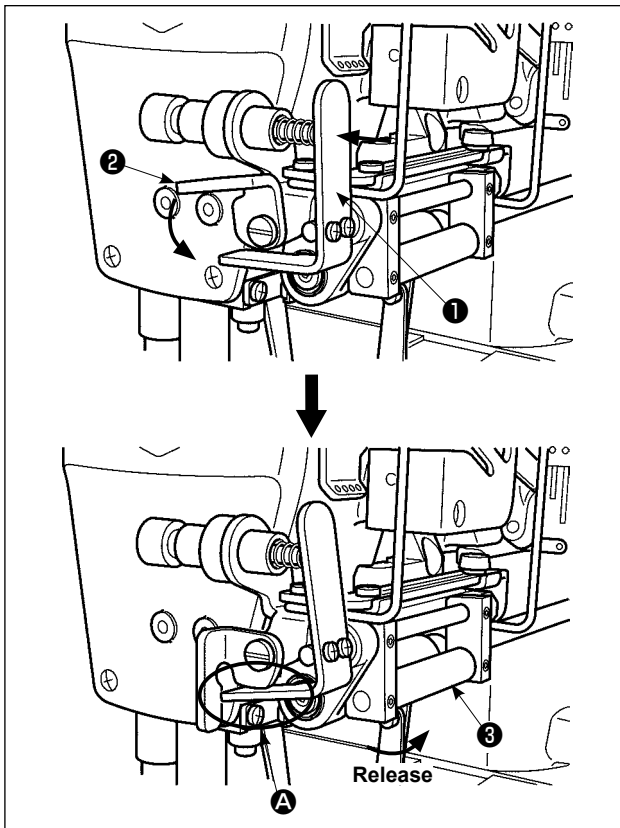

When operating the sewing machine with elastic tape unused, the roller is maintained in the release state by using the stopper.

- 1) Pressing the upper part of presser plate ① with fingers, turn stopper ② in the direction of the arrow.
- 2) When stopper ② is turned up to the position A, roller ③ is held at the release position.

10. REMOVING THE TAPE GUIDE SECTION



WARNING :

To protect against possible personal injury due to abrupt start of the machine, be sure to start the following work after turning the power off and ascertaining that the motor is at rest.

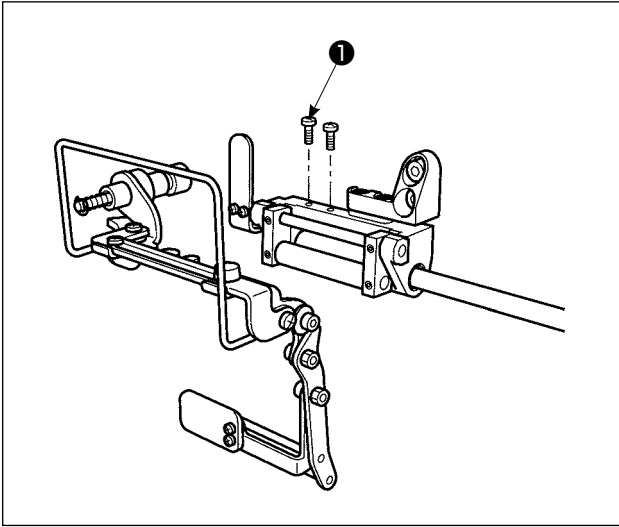

Remove mounting screw ❶. Then, the tape guide section can be removed in the assembled state.