

***ENGLISH***

**Reverse feed lever (asm)  
INSTRUCTION MANUAL**

## Assembling procedure for the reverse feed lever (asm.)



### WARNING :

To protect against possible personal injury due to abrupt start of the machine, be sure to start the following work after turning the power off and ascertaining that the motor is at rest.

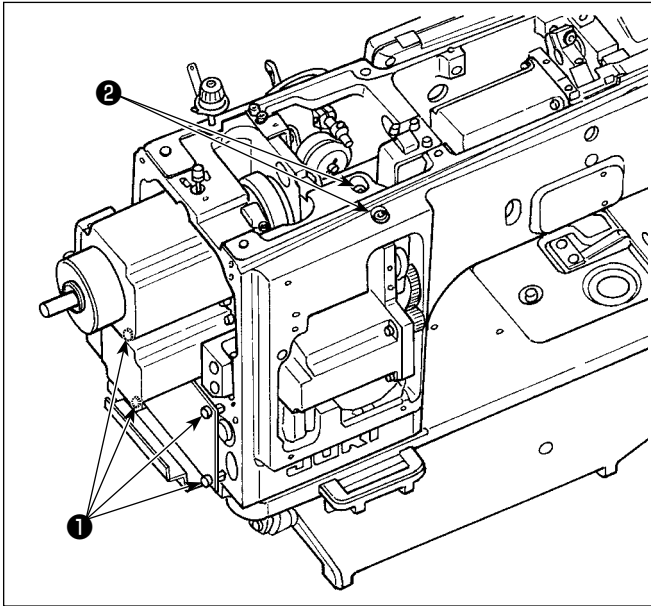

- 1) Detach screws ❶ and ❷, and detach the INT PCB and presser motor base.

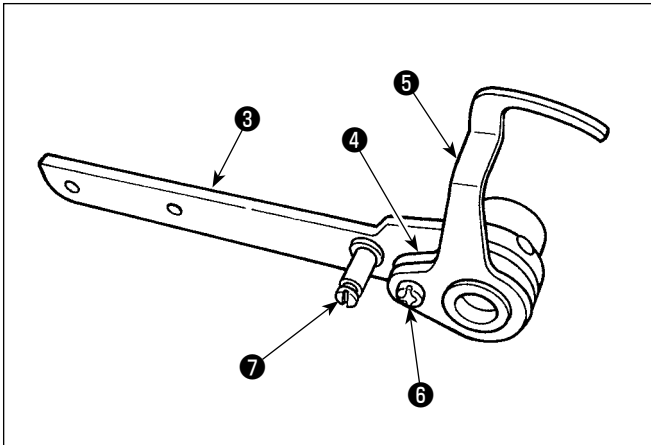

- 2) Secure spacer ❹ and reverse feed sensor plate ❺ to reverse feed lever plate (asm.) B ❸ with screw ❻ .  
Fix reverse feed sensor plate ❺ at the center of slot.  
Attach spring peg shaft ❼ to reverse feed lever plate (asm.) B ❸ .

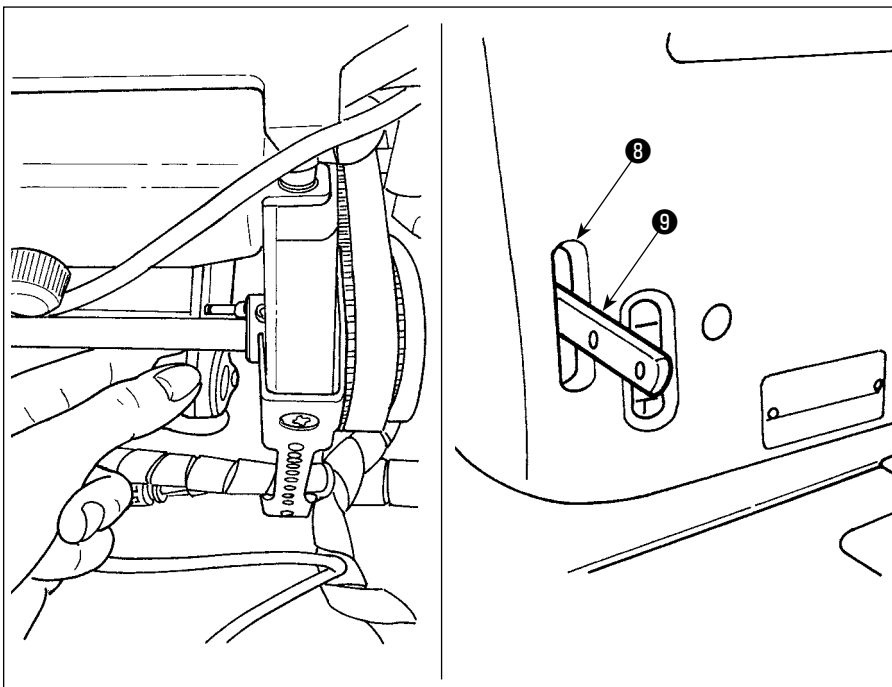

- 3) Insert reverse feed lever plate (asm.) B ❸ that you have assembled in Step 2) from under the bed. Position reverse feed lever plate ❹ so that it juts out from reverse feed lever hole ❽ in the arm.

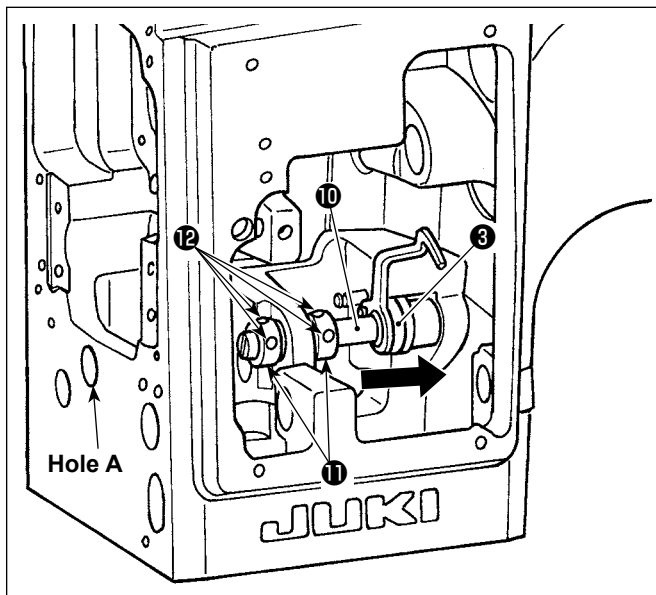

- 4) Put reverse feed lever shaft **10** through hole **A** in the side face of the arm. Then, pass it through the holes in the arm, in thrust collar **11** and in reverse feed lever plate (asm.) **B 3**.
- 5) Insert reverse feed lever shaft **10** in the direction of arrow until it will go no further. Then, fix reverse feed lever shaft **10** with thrust collar set-screw **12**.

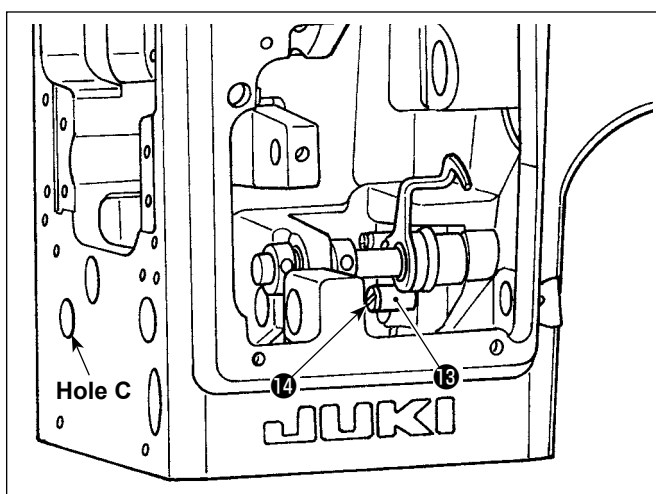

- 6) Put reverse feed lever stopper **13** through hole **C** in the side face of the arm and attach it to the arm with screw **14**.

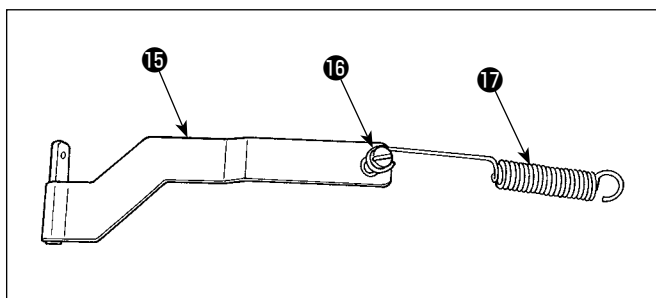

- 7) Attach spring peg shaft **16** to spring peg plate **15**. Put reverse feed return spring **17** on spring peg shaft **16**.

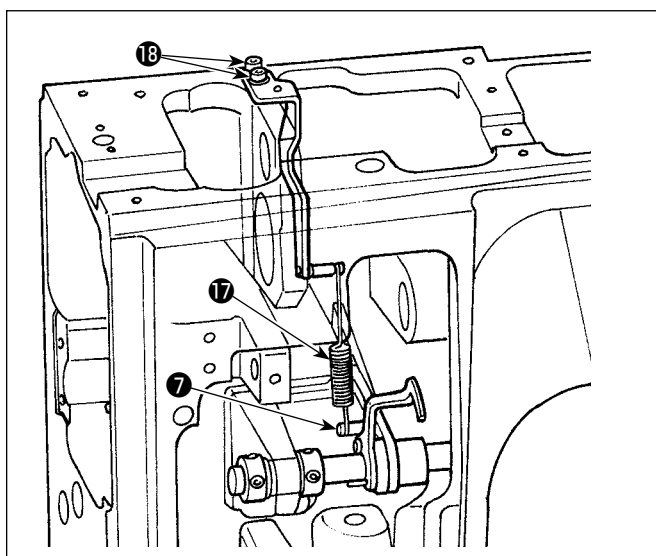

- 8) Put reverse feed lever return spring **17** that you have assembled in Step 7) on spring peg shaft **7**. Then, attach spring peg plate **15** to the arm with screws **18**.

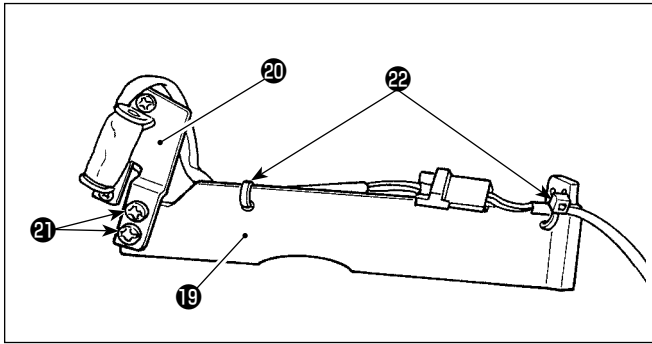

- 9) Secure reverse feed sensor mounting plate asm. 20 to reverse feed sensor base 19 with screws 21 .  
Fix the cord with cable clip bands 22 .

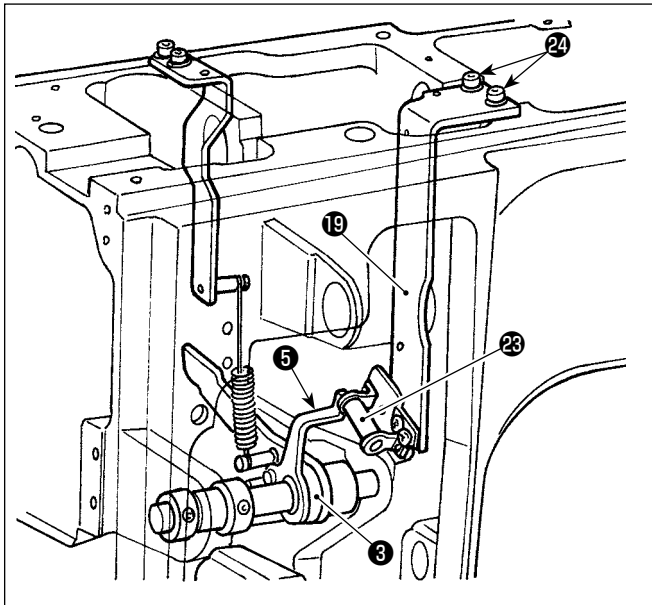

- 10) Insert the top end of reverse feed sensor plate 5 into reverse feed sensor 23 of reverse feed sensor base 19 that you have assembled in Step 9).
- 11) Move reverse feed lever plate (asm.) B 3 up and down until it is brought to the position where reverse feed sensor 23 does not come in contact with reverse feed sensor plate 5 . Then, fix reverse feed sensor base with screws 24 .

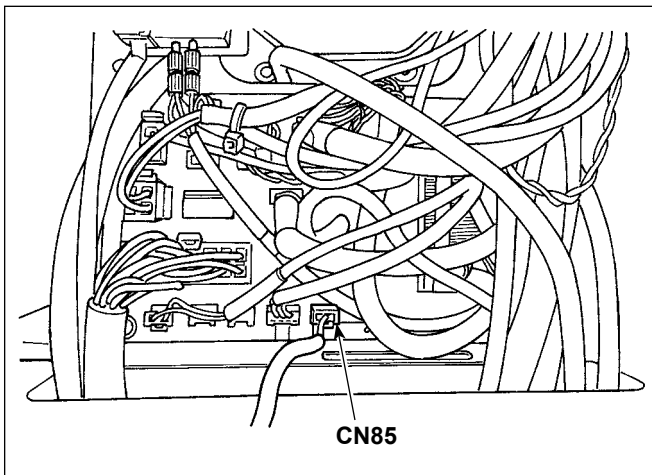

- 12) Route the cord of the reverse feed sensor appropriately from the top surface of the arm.
- 13) Connect the connector of the reverse feed sensor to CN85 on the INT PCB.

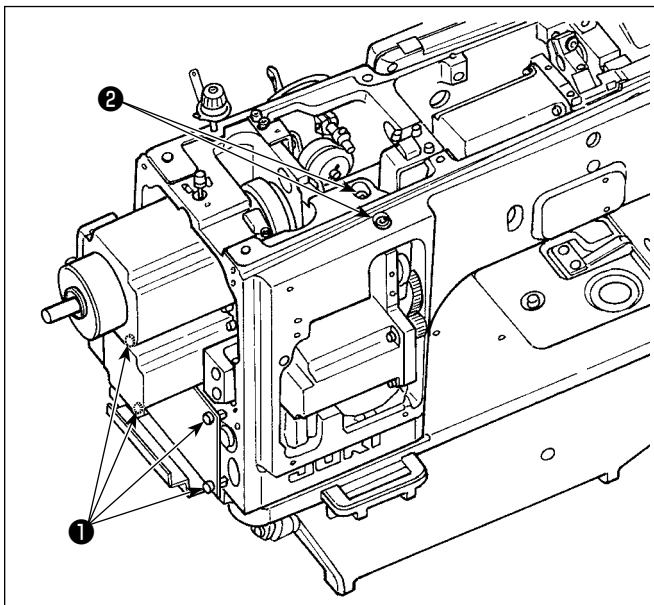

14) Attach the INT PCB and presser motor base in place with screws **1** and **2** .

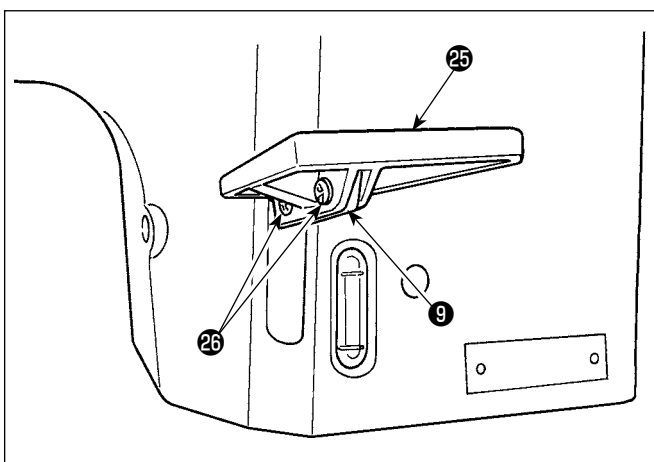

15) Attach reverse feed lever **25** to reverse feed lever plate **9** with screws **26** .