

Tape Attaching Sewing Unit

JTR-MS1190 / TA Series

INSTRUCTION MANUAL



No.JTR000

MS1190TA-TM

CONTENTS

- 1) CONFIGURATION OF THE MACHINE**
- 2) SPECIFICATION**
- 3) INSTALLATION**
- 4) PREPERATION FOR OPERATION**
- 5) PANEL**
- 6) ADJUSTMENT**
- 7) LIST OF PATTERN DATA**
- 8) CAUSES AND COUNTERMEASURES**

1) CONFIGURATION OF THE MACHINE

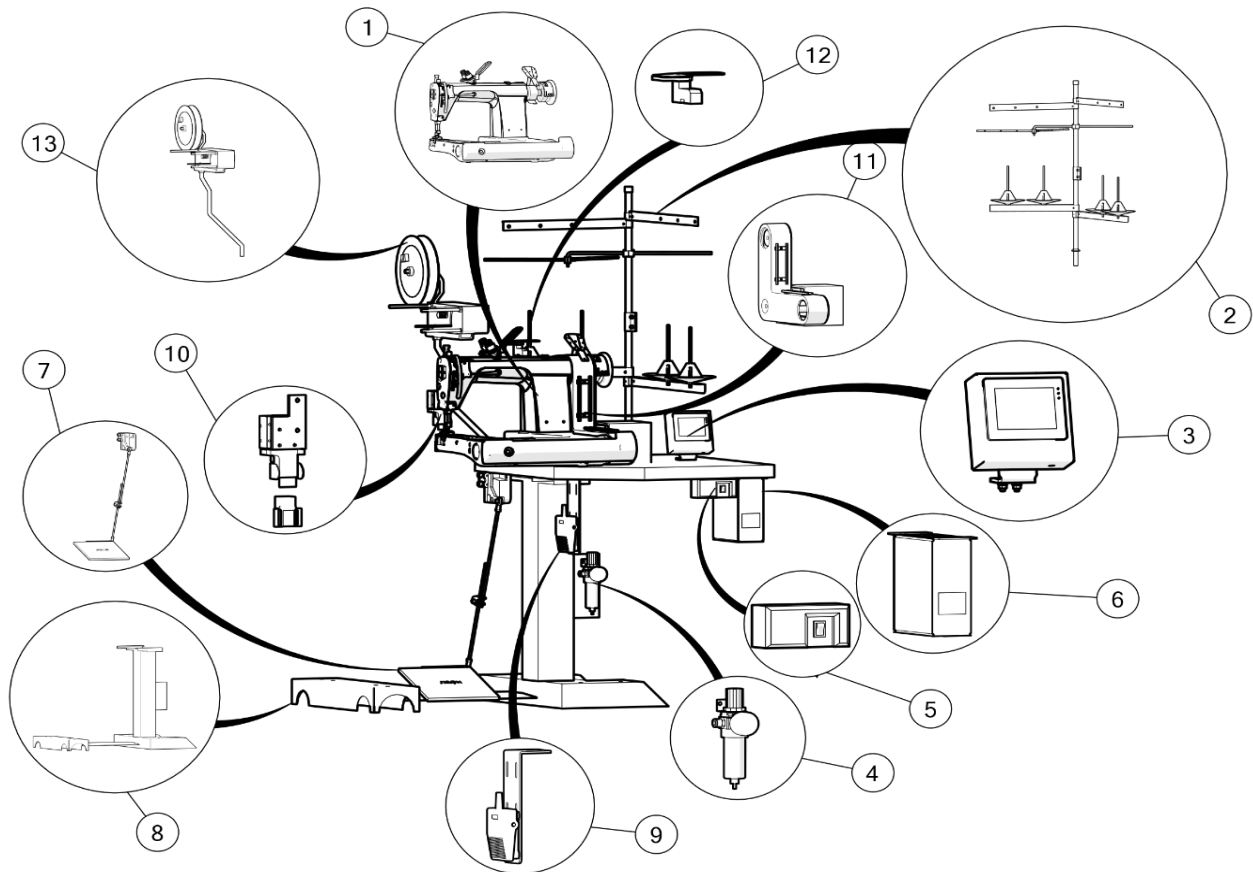

| | | | |
|----------|-------------------|-----------|----------------------------|
| 1 | MACHINE HEAD | 8 | CHASSIS GROUP |
| 2 | THREAD STAND | 9 | KNEE SWITCH |
| 3 | PANEL | 10 | KNIFE GROUP |
| 4 | AIR REGULATOR | 11 | MOTOR - SPROCKET GROUP |
| 5 | MAIN SWITCH | 12 | PRESSER FOOT LIFTING GROUP |
| 6 | JTRON CONTROL BOX | 13 | TAPE STAND |
| 7 | PEDAL | | |

2) SPECIFICATION

| No. | Category | Description |
|-----|------------------------|---|
| 1 | MACHINE HEAD | MS1190 |
| 2 | MODEL NAME | JTR-MS1190/TA |
| 3 | MAIN MOTOR | Hohsing M5-60-JA2BL |
| 4 | MAIN MOTOR DRIVE | Hohsing GD60-4 |
| 5 | MAXIMUM SEWING SPEED | 5000 sti/min, at the delivery: 4000 sti/min |
| 6 | STITCH LENGTH | 2.5 mm - 4mm, delivery stitch length: 2.5mm |
| 7 | NEEDLE TYPE | GB / UY128 #12 - 14 |
| 8 | GAUGE | Original Juki Gauge |
| 9 | SEWING SPECIFICATIONS | THIN TO MEDIUM THICKNESS |
| 10 | TARGET PROCESS | SHOULDER TO SHOULDER TAPE ATTACHING |
| 11 | AIR PRESSURE | Min: 0.6 MPa Max: 0.8 MPa Delivery: 0.6 MPa |
| 12 | AIR CONSUMPTION | 6 L / min |
| 13 | VOLTAGE CLASSIFICATION | Single-phase 220 - 240 V / 50 Hz |
| 14 | CAPACITY | 2700 - 3000 pcs / 9hours |
| 15 | DAILY PIECE COUNTER | YES |
| 16 | POWER CONSUMPTION | 480VA |

3) INSTALLATION

3.1) The machine is delivered as below

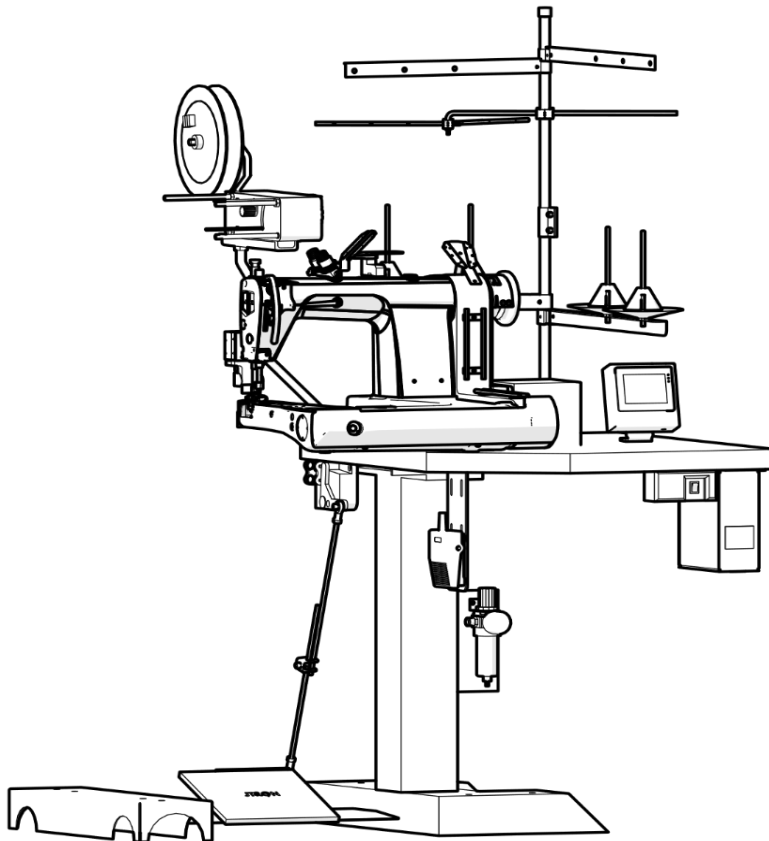

3.2) Connecting the power supply

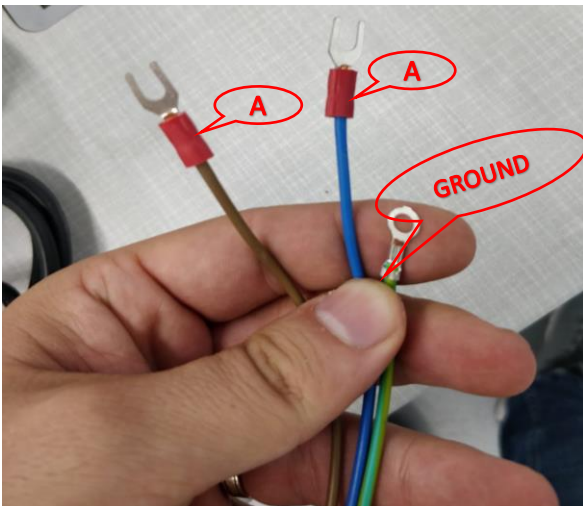

The machine is not supplied with a power plug. It is therefore necessary for you to select a plug that matches the receptacle available under a given operating environment and attach it to the power cable.

3.3) Connect the air tube to the air regulator.

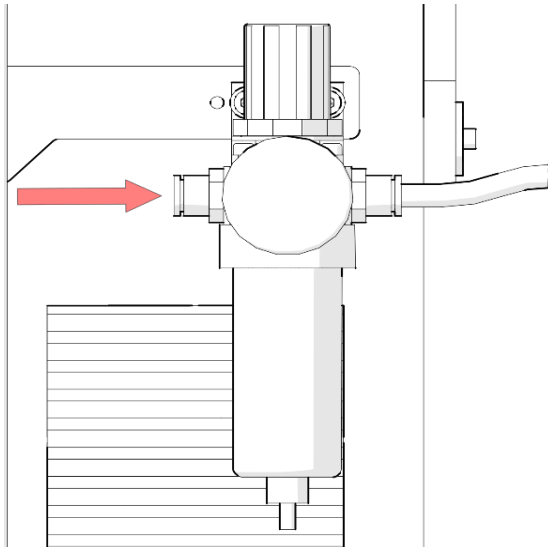

4) PREPARATION FOR OPERATION

4.1) Please put the JUKI original oil. (Please refer to machine head instructions MS-1190 Series)

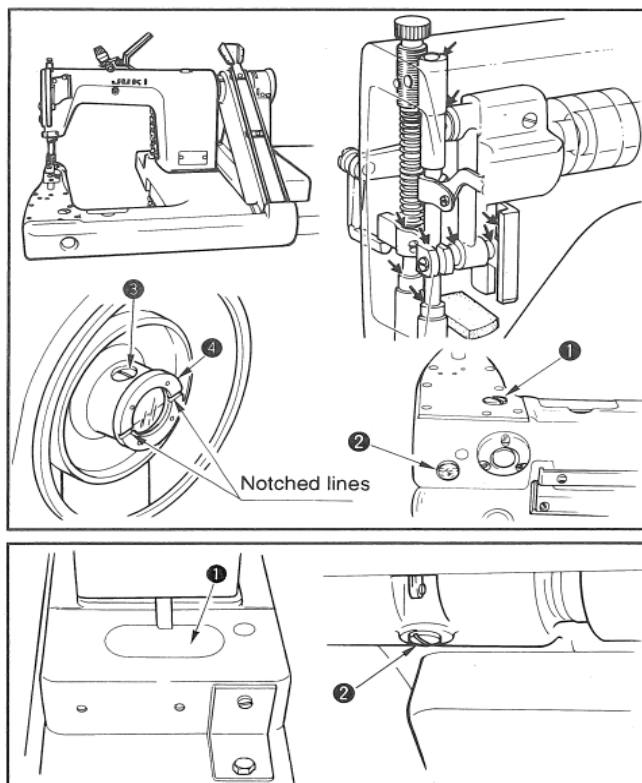

* Before operating the sewing machine

- 1) Remove screw ① from the lubrication hole. Pour New Defrix Oil No. 1 from the hole until the oil surface reaches the mark on oil sight window ②.
- 2) Turn the handwheel until the notched lines on the oil cup ④ are leveled. Now, remove screw ③ from the lubrication hole, and pour the oil until the oil surface reaches the notched lines on the oil cup (approx. a half of the oil capacity of the cup).
- 3) Run the sewing machine for a few minutes, then check the amount of oil again. If the amount of oil is insufficient, pour the oil further until the machine is filled with a proper amount of oil.
- 4) If the sewing machine has not been used for a long time, lubricate the section marked with an arrow (➡) with a few drops of oil.

(Caution) To operate the sewing machine for the first time after the set-up of the machine or after it has not been used for a long time, fill the oil cup fully with the oil. Check that the oil level is always held within the red marked area on the oil sight window.



* Draining oil

- 1) If the oil has gathered in groove ① of the oil reservoir, wipe it off with rags.
- 2) Extract the oil which has gathered in the bed, from time to time, by removing cover ② from the draining hole in the hook driving shaft.

4.3) Switch on the machine.

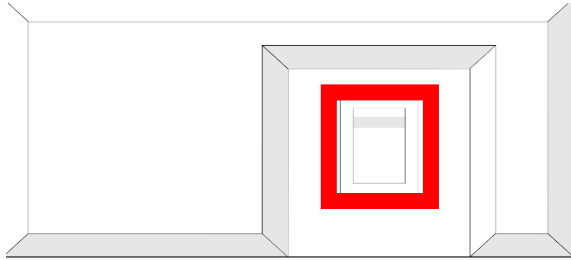

5) PANEL

5.1) Starting Display (The language can be selected on this screen.)



5.2) Adjustment Page



1 - Photocell input knife initial step : Cutting length at the beginning of tape

2 - Photocell output knife initial step : Cutting length at the end of tape

3 - Knife runtime : Working time of the knife

4 - Current number : Daily counter

6) ADJUSTMENT

6.1) Change the cutting knife.

6.1.1) Remove the screws.

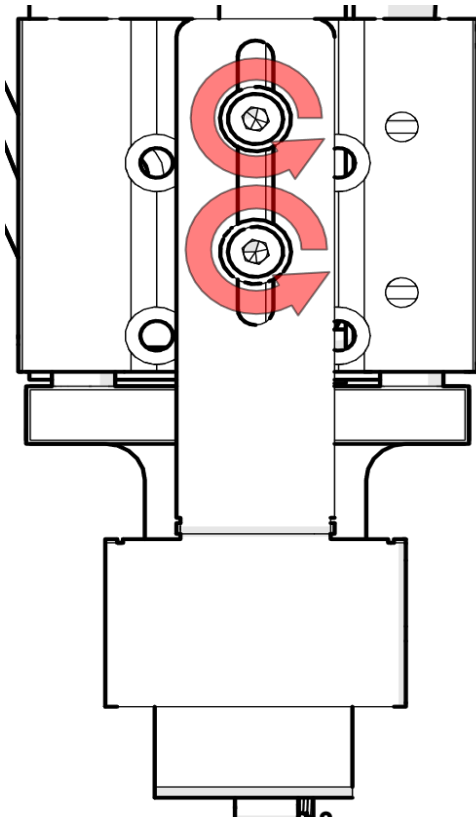

6.1.2) Remove the knife guide.

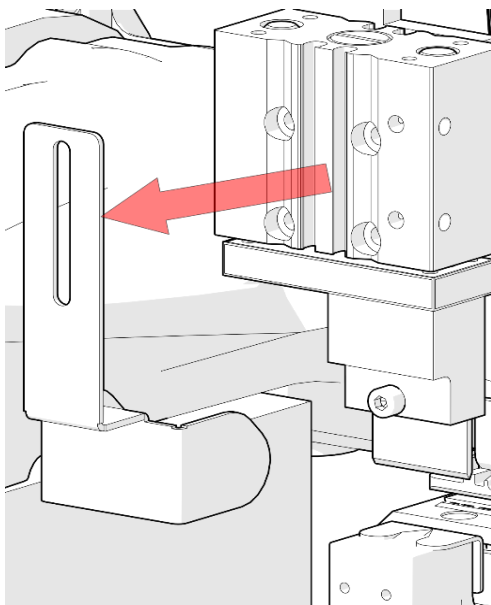

6.1.3) Loosen the screw and remove the knife.

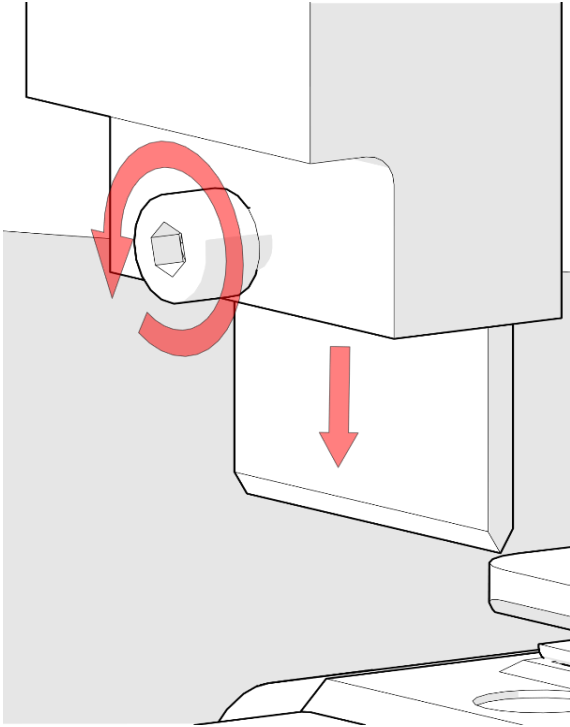

6.1.4) Install the new knife and tighten the screw.

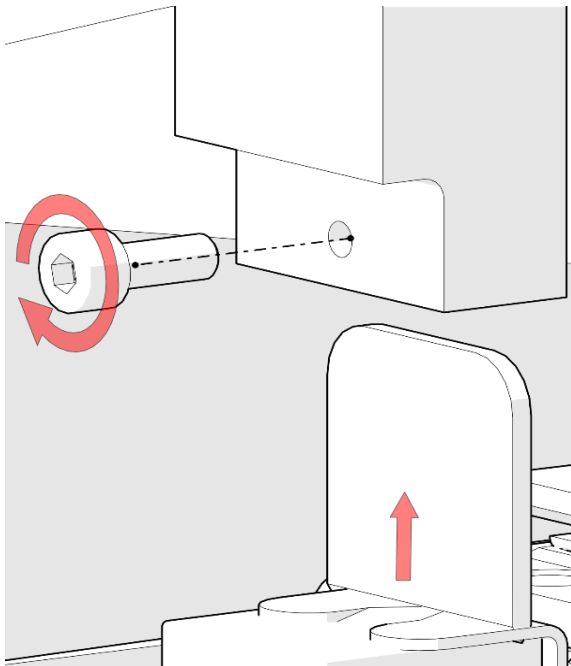

6.1.5) Install the knife guide.

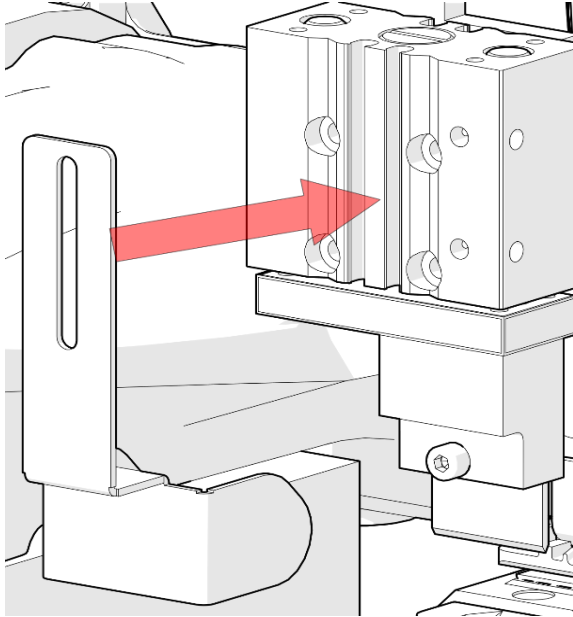

6.1.6) Install the screws.

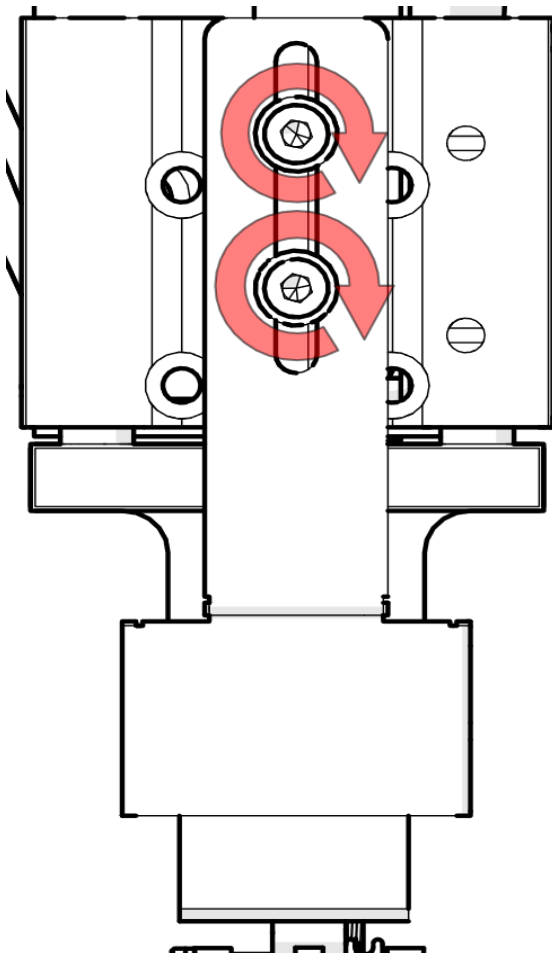

7) LIST OF PATTERN DATA(SHIPPING VALUES)



8) CAUSES AND COUNTERMEASURES

Q.1) Needle or looper thread breakage.

A1) Check thread, thread path, thread tension, needle and needle heat.

Q.2) Double chain stitches are skipped.

A2) Check needle, needle height, needle guard, needle heat, looper, adjustment of looper and thread tension.

| | | |
|---------------------|---|---|
| Company Name | : | JUKI SINGAPORE PTE LTD. |
| ADD | : | 20 BENDEMEER ROAD,#04-12 BS BENDEMEER CENTRE SINGAPRE 339914 |
| PHONE | : | (65) 6553-4388 |
| HTTP | : | http://www.juki.com.sg |
| E-Mail | : | we.sgp-sales@ml.juki.com |
| Company Name | : | JUKI Machinery Vietnam Company Ltd |
| ADD | : | 153 HOA LAN STR., WARD 2, PHU NHUAN DIST., HO CHI MINH CITY, VIETNAM |
| PHONE | : | (84) 28-35178833 |
| FAX | : | (84) 28-35178318 |
| E-Mail | : | sales@jukimv.com |
| Company Name | : | JUKI Machinery Bangladesh Ltd |
| ADD | : | NATORE TOWER(5TH FLOOR) PLOT#32-D & 32-E, ROAD#2, SECOR#03 ,UTTARA MODEL TOWN, DHAKA, BANGLADESH |
| PHONE | : | (880)2-48954731 |
| FAX | : | (880)2-48954733 |
| E-Mail | : | vl.mbl-info@ml.juki.com |
| Company Name | : | JUKI India Private Limited |
| ADD | : | GAOUND AND 1ST FLOOR, NO.1090/I, 18TH CROSS ROAD,3RD SECTOR, HSR LAYOUT BANGALORE-560 102, KARNATAKA STATE, INDIA |
| PHONE | : | (91)80-4251-1900 |
| FAX | : | (91)80-4251-1999 |
| HTTP | : | http://jukiindia.com |
| E-Mail | : | jukibl@jukiindia.com |
| Company Name | : | JUKI CENTRAL EUROPE |
| ADD | : | UL. POLECZKI 21(PLATAN PARK C) 02-822 WARSAW, POLAND |
| PHONE | : | (48)22-545-0400 |
| FAX | : | (48)22-545-0411 |
| HTTP | : | http://jukieurope.com |
| Company Name | : | JUKI America INC |
| ADD | : | 8500 NW 17TH STREET, SUITE 100, DORAL, FL 33126-1035, U.S.A. |
| PHONE | : | (1)305-594-0059 |
| HTTP | : | https://juki.com |
| Company Name | : | JUKI MIDDLE EAST (JUKI SINGAPORE PTE. LTD. UAE BRANCH) |
| ADD | : | OFFICE NO, 2511. BLOCK A JAFZA 1, PO BOX 18031, JEBEL ALI, DUBAI UAE |
| PHONE | : | (971)4-8833228 |
| FAX | : | (971)4-8833230 |
| HTTP | : | http://www.juki.com.sg |
| Company Name | : | JUKI (China) CO LTD. |
| ADD | : | ROOM 901-903, HAILIANG BUILDING, NO.22, LANE 118 ZHONGJIANG ROAD, PUTUO DISTRICT SHANGHAI, CHINA, 200062 |
| PHONE | : | 8621-6236-8888 |
| HTTP | : | http://www.jukichina.com |



JUKI CORPORATION

SEWING MACHINERY & SYSTEMS BUSINESS UNIT

2-11-1, Tsurumaki, Tama-shi, Tokyo 206-8551, Japan

Phone: (81) 42-357-2211

