

ENGLISH

DDL-8000CS
Single-touch Presser Foot Kit
INSTRUCTION MANUAL

CONTENTS

1. General.....	1
2. Single-touch presser foot kit parts list	1
3. How to assemble.....	2
3-1. Removing the face plate	2
3-2. Removing the presser foot	2
3-3. Removing the presser bar bracket.....	3
3-4. Installing the presser bar (asm.)	3
3-5. Installing the single-touch presser foot joint	4
3-6. Installing the presser foot adjustment screw	4
3-7. Positioning the presser bar bracket	4
4. How to replace the single-touch presser foot kit.....	5
4-1. Replacing the single-touch presser foot kit.....	5
5. How to adjust the single-touch presser foot position.....	6

1. General

The single-touch presser foot kit is an optional parts kit that allows you to easily replace the presser foot.

2. Single-touch presser foot kit parts list

Single-touch presser foot kit parts number : 40299038

· List of parts supplied with the machine

No.	Parts No.	Description	Qty
❶	40299039	Presser foot joint (asm.)	1
❷	SS7091110TP	Setscrew	1
❸	40299040	Presser bar (asm.)	1

Single-touch presser foot joint kit parts number : 40299044

· List of parts supplied with the machine

No.	Parts No.	Description	Qty
❶	40299039	Presser foot joint (asm.)	1
❷	SS7091110TP	Setscrew	1

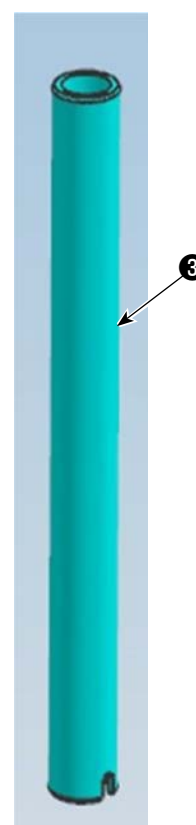
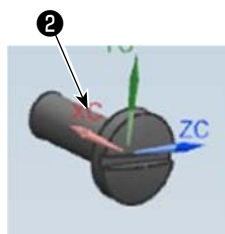
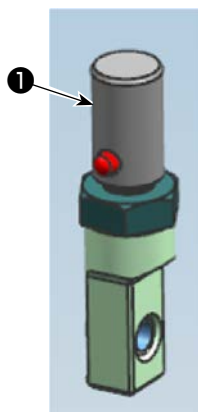

3. How to assemble



WARNING :

To protect against possible personal injury due to abrupt start of the machine, be sure to start the following work after turning the power off and ascertaining that the motor is at rest.

3-1. Removing the face plate

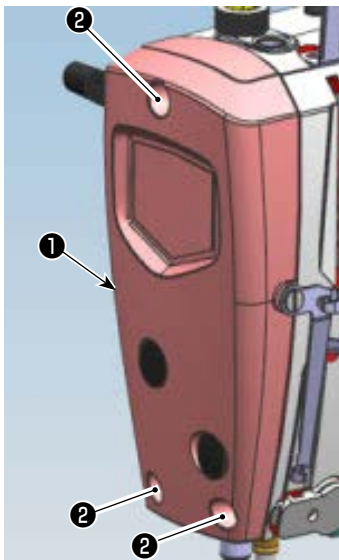

- 1) Loosen the three setscrews ② and then remove the face plate ①.

3-2. Removing the presser foot

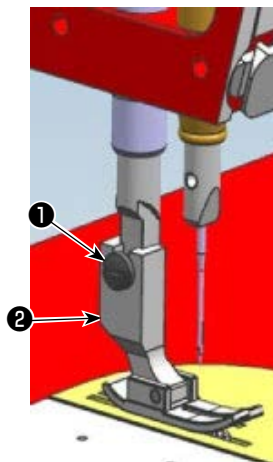

- 1) Loosen the setscrew ① and then remove the presser foot ② and the setscrew ①.

3-3. Removing the presser bar bracket

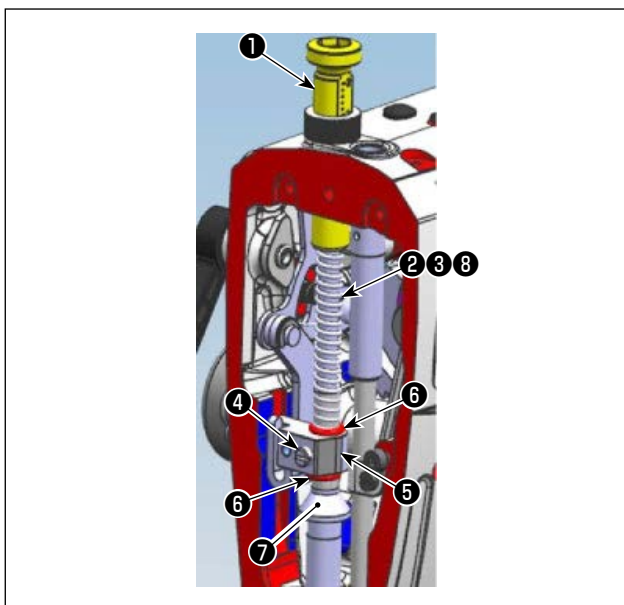

- 1) Remove the presser foot adjustment screw ❶ , presser foot adjustment spring ❷ , and presser guide bar ❸ .
- 2) Loosen the setscrew ❹ and then remove the presser bar bracket ❺ , O-ring ❻ (2 pieces), presser bar oil-proof rubber ❼ , and presser bar ❽ .

3-4. Installing the presser bar (asm.)

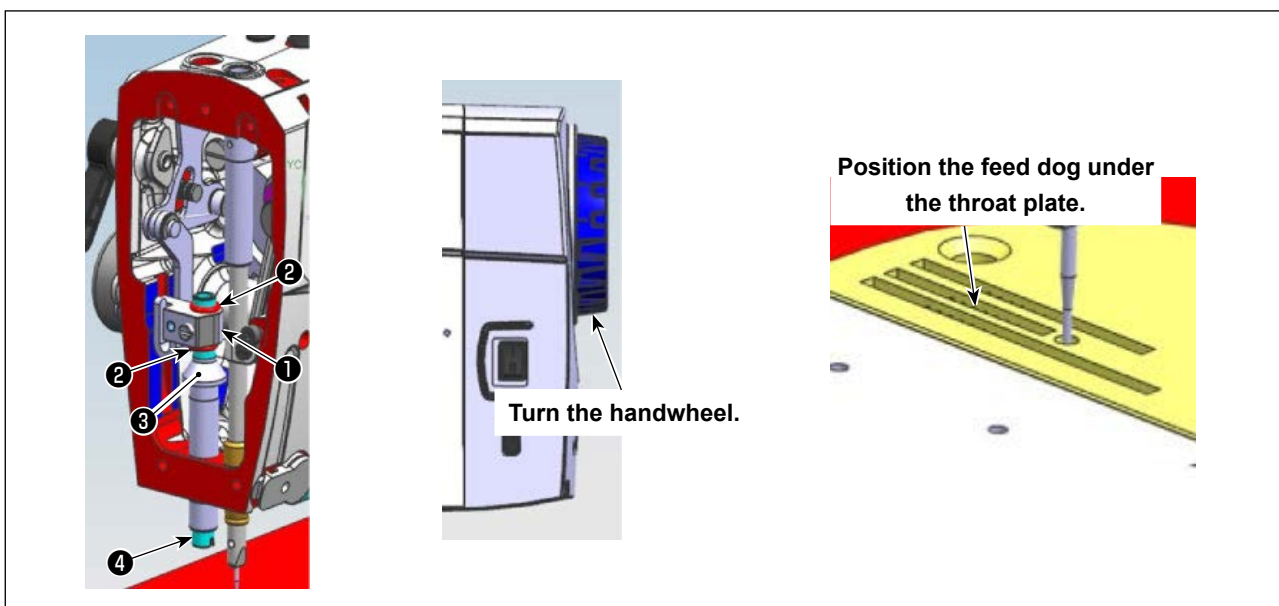

- 1) Apply JUKI Grease A to the periphery of the presser bar (asm.) ❹ .
- 2) Attach the presser bar (asm.) ❹ and then install presser bar oil-proof rubber ❸ , O-ring ❷ , presser bar bracket ❶ , and O-ring ❷ , in that order.
- 3) Turn the handwheel and then position the feed dog under the throat plate.

3-5. Installing the single-touch presser foot joint

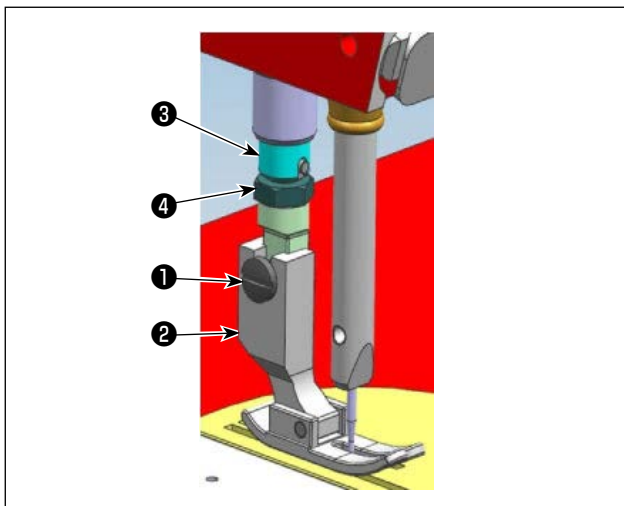

- 1) Face the groove in the presser bar (asm.) **3** toward the operator, and then firmly attach the joint (asm.) **4** all the way in.
- 2) Attach presser foot **2** to the joint (asm.), and then adjust the position by rotating the presser foot (asm.) **3** so that the center of the groove in the presser foot **2** is aligned with the needle.
- 3) Tighten setscrew **1** to secure presser foot **2**.

3-6. Installing the presser foot adjustment screw

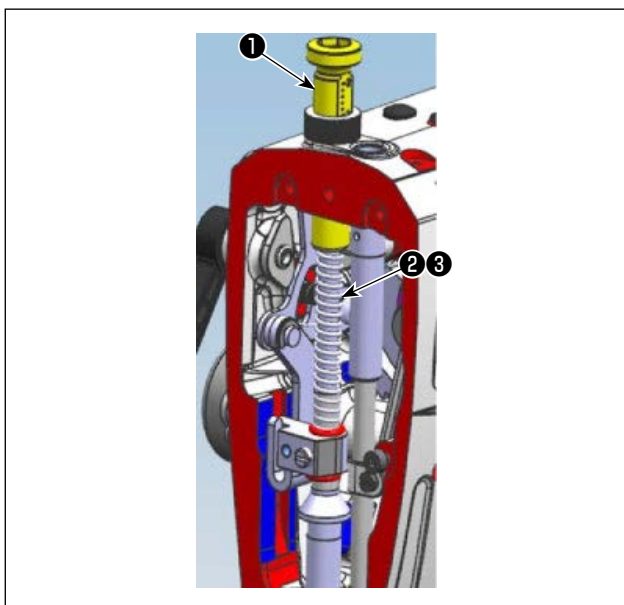

- 1) Pass the presser foot adjustment spring **3** through the presser guide bar **2** and insert it into the sewing machine.
- 2) Attach the presser foot adjustment screw **1**.

3-7. Positioning the presser bar bracket

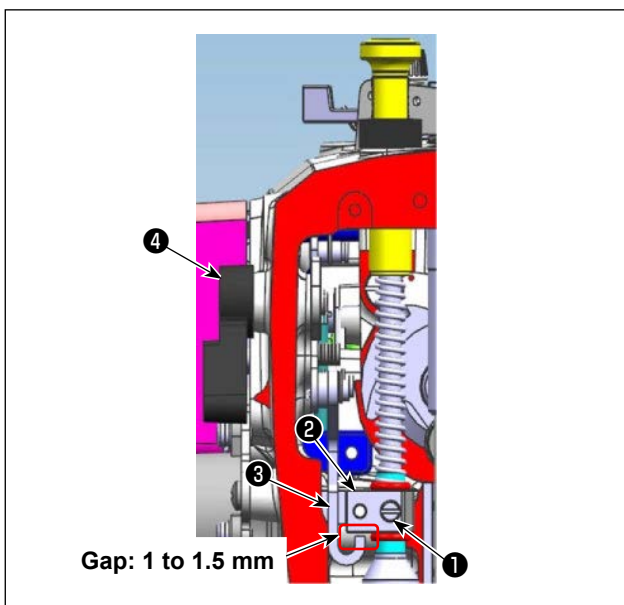

- 1) Turn the presser foot lifting lever **4** to adjust the gap between the presser bar bracket **2** and the presser lever **3** to approximately 1 to 1.5 mm.
- 2) Tighten the setscrew **1** while keeping the position described in item 1. above.
 - * After tightening the setscrew **1**, be sure that the center of the groove in the presser foot is aligned with the needle.
- 3) Assemble the disassembled parts back to their original state.

4. How to replace the single-touch presser foot kit



WARNING :

To protect against possible personal injury due to abrupt start of the machine, be sure to start the following work after turning the power off and ascertaining that the motor is at rest.

4-1. Replacing the single-touch presser foot kit

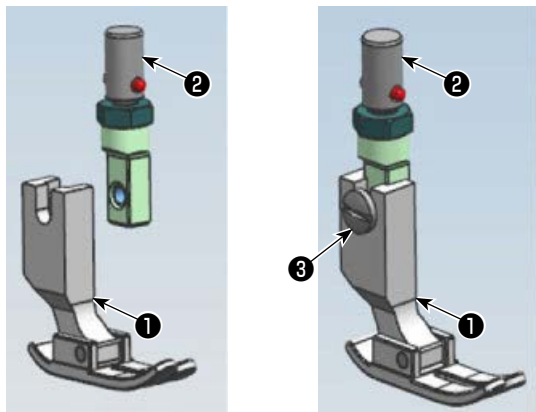

- 1) Align the flap part of the joint (asm.) ② with the presser foot ① .
- 2) Tighten the setscrew ③ to secure presser foot ① .

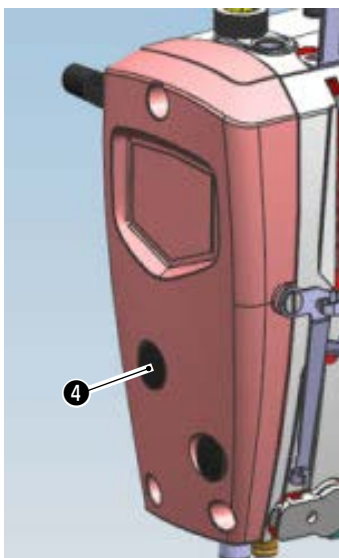

- 3) Remove the face plate rubber plug ④ .

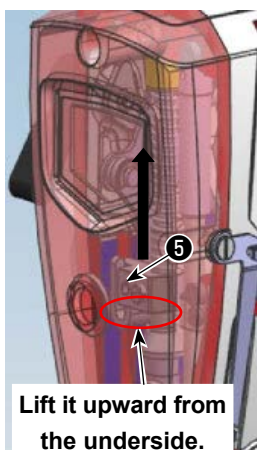

- 4) Insert a tool or the like into the hole in the face plate as shown as shown in the left figure, hook it onto the underside of the presser bar bracket ⑤ , and lift it upward.
- 5) Since the presser foot will rise, while in this state, pull the joint (asm.) ② downward by hand to remove it.

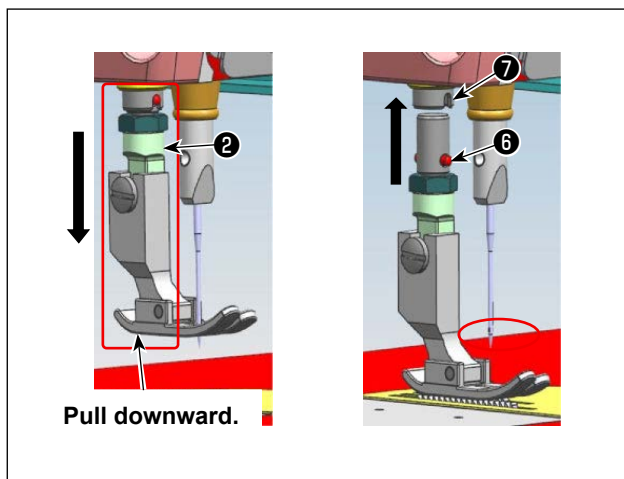

- 6) Once the joint (asm.) ② and presser foot ① are assembled in step 2, align the pin ⑥ of the single-touch presser foot to be replaced with the groove in the presser bar ⑦, and then insert the single-touch presser foot into the hole in the presser bar ⑦ by hand.
- * Insert the single-touch presser foot firmly all the way in.
- 7) Assemble the disassembled parts back to their original state.

5. How to adjust the single-touch presser foot position



WARNING :

To protect against possible personal injury due to abrupt start of the machine, be sure to start the following work after turning the power off and ascertaining that the motor is at rest.

The single-touch presser foot is shipped with adjustments for height and rotation positions already made. If you need to adjust the presser foot position due to differences in presser foot types or other factors, loosen the nut ① and rotate joint A ② to change both the vertical and rotational positions.

After adjusting the position, tighten the nut ① to fix joint A ②.

