

Installing and connecting the supplied reactor box and ring core

The installation and connection methods vary depending on the supplied reactor box.

Refer to the following documents for installation.

- When using the following, refer to **"4. Installing the reactor box and ring core [Only for the EU type models]" p.2**.

	No.	pc.
1	402-33439	REACTOR 8A
2	402-47139	REACTOR_COVER_CABLE_SET_7A
3	402-37435	ACCESSORIES_PARTS_1P_CE_ASSY

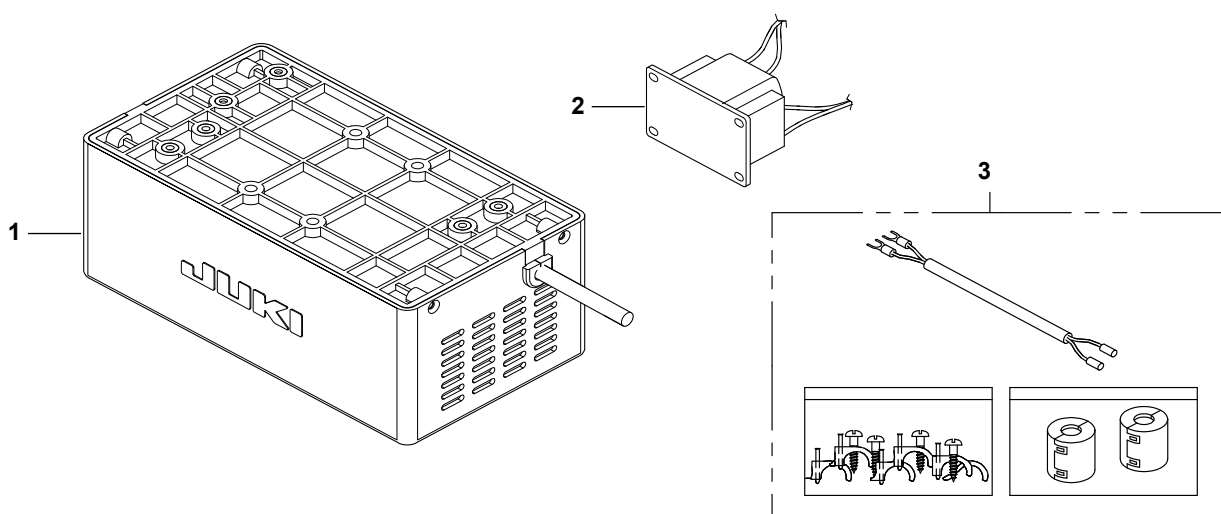

- When using the following, refer to **"4. Installing the reactor box [Only for the EU type models]" p.5** or **"II-4. Installing the reactor box (Only for EU type models)"** in the Instruction Manual for the DDL-7000A.

	No.	pc.
1	402-96993	REACTOR_BOX_7A
2	402-98581	ACCESSORIES_PARTS_1P_CE_ASSY

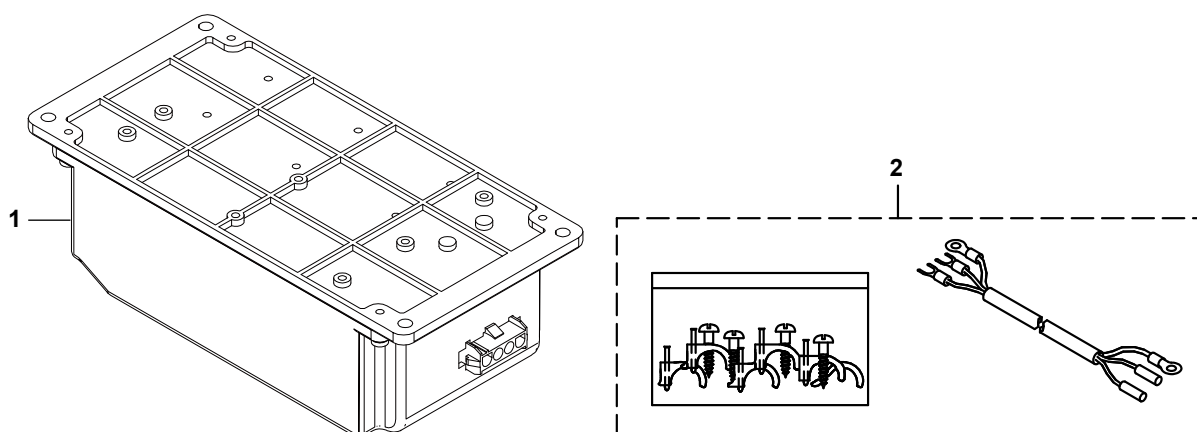

4. Installing the reactor box and ring core [Only for the EU type models]

* For the EU-type models, install the reactor box that is supplied with the sewing machine.

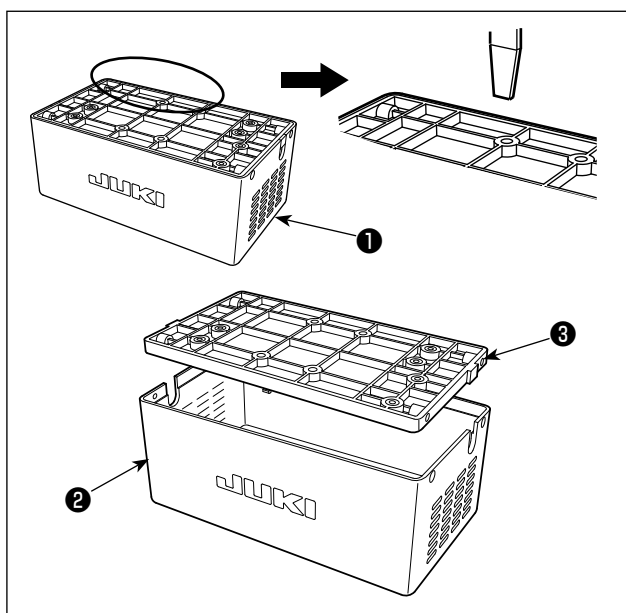

1) Detach reactor cover ② from reactor box ① to separate from reactor base asm. ③.

* The reactor cover can be detached with ease by inserting a tool that has a thin flat tip such as a flat-blade screwdriver between the cover and base.

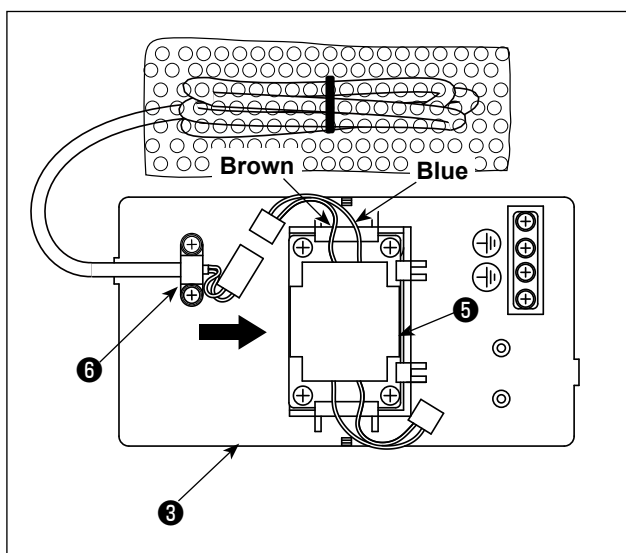

2) Slide reactor ⑤ in the direction of the arrow to insert into reactor base asm. ③.

- Caution**

 1. When inserting the reactor, detach bundled wire clamp ⑥ beforehand.
 2. Insert reactor ⑤ into the reactor base asm. while facing brown and blue lead wires side upward.

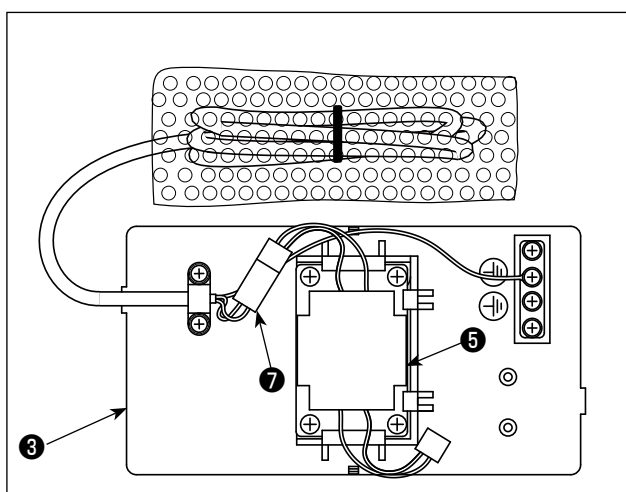

3) Connect the connector ⑦ of the power cord that is fixed to reactor base asm. ③ to the connector of reactor ⑤.

- Caution**

Be sure to insert the former fully into the latter until the connector is locked.

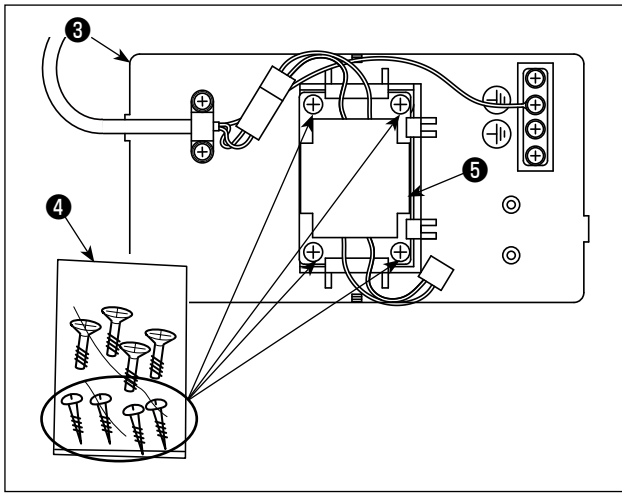

- 4) Take out wood screws (ST4.2 x 25) from screw bag ④ . Secure reactor base asm. ③ and reactor ⑤ to the undersurface of sewing machine table with the wood screws (at four locations).



Refer to the instruction figure shown in the following step of procedure 11) for the mounting positions of the reactor cover and reactor base asm.

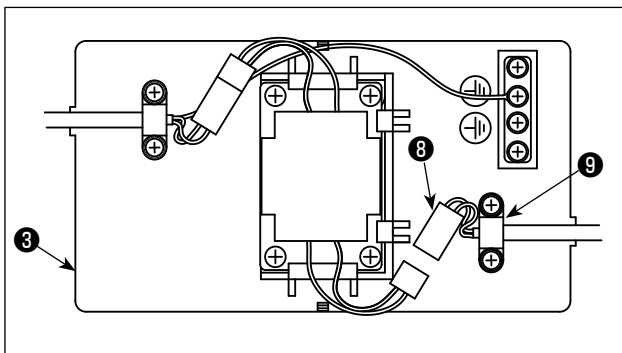

- 5) Secure power cord asm. ⑧ coming from the electrical box to reactor base asm. ③ with bundled wire clamp ⑨ .

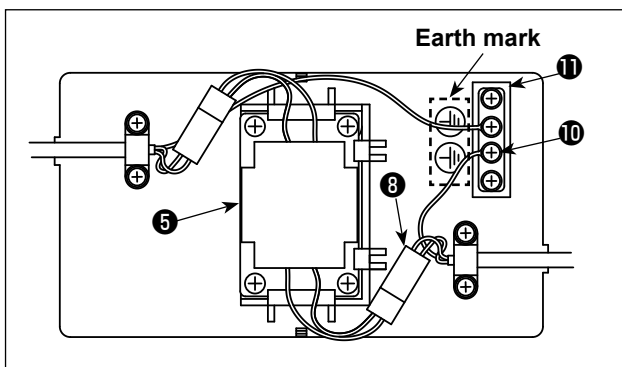

- 6) Connect the connector of power cord asm. ⑧ to connector of reactor ⑤ .
7) Secure earth terminal ⑩ of power cord asm. ⑧ to earth base ⑪ with a screw.



Secure the earth terminal to the screw with earth mark ⑩ .

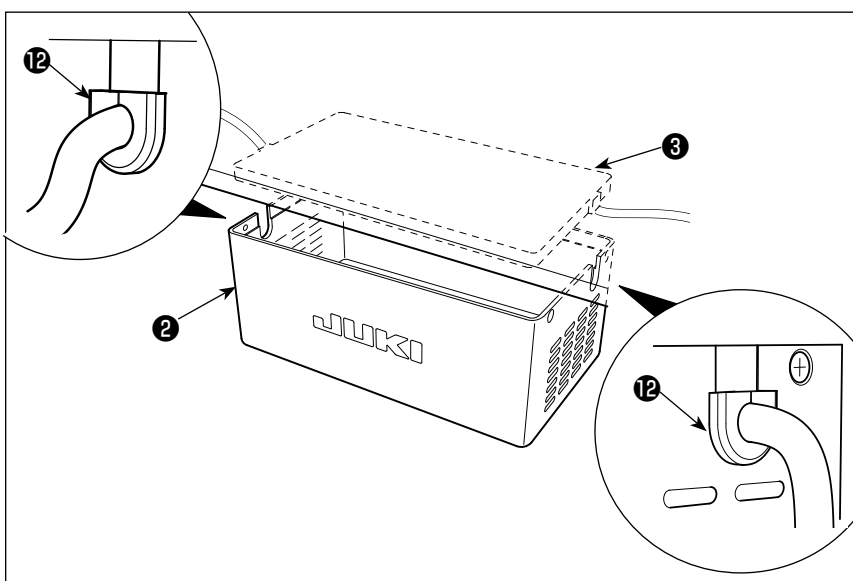

- 8) Fit reactor cover ② over reactor base asm. ③ .



Take care not to allow the cord to be caught under reactor cover ② .
Pass the power cord through cord bushing ⑫ . Then, insert the power cord into the slit portion of reactor cover ② and hold it with reactor base asm. ③ .

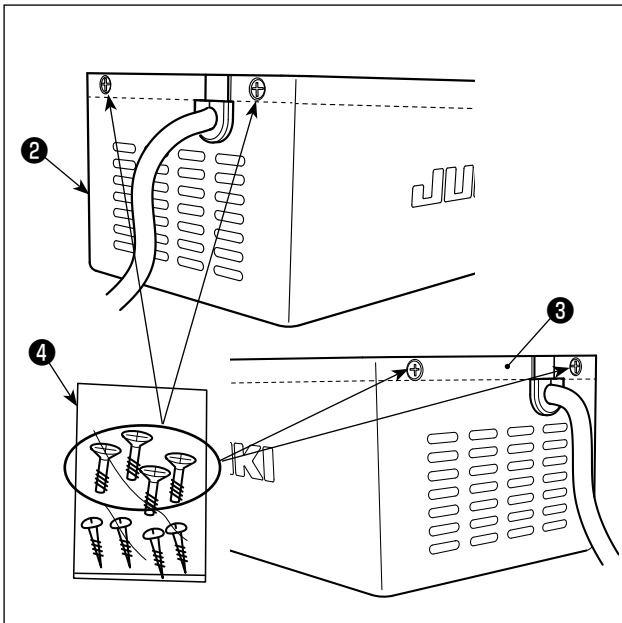

- 9) Take out reactor cover fixing screws from screw bag ④ . Secure reactor cover ② to reactor base asm. ③ with the fixing screws (at four locations).

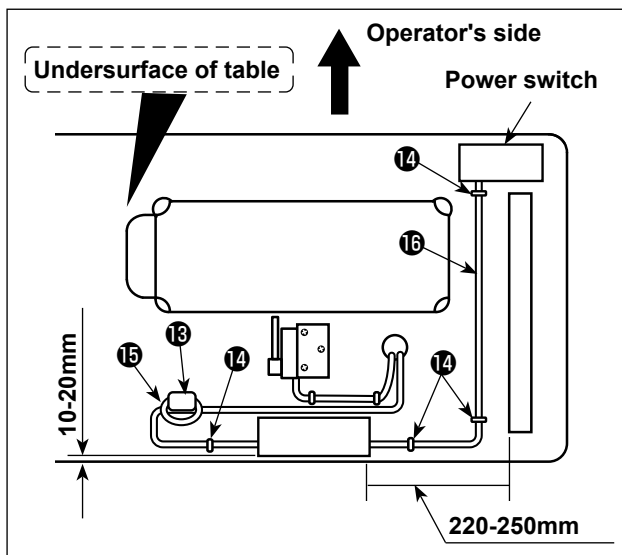

- 10) Install ring core ⑬ .

For core ⑬ , clamp the power cord of the electrical box after winding the cable round the torus of the ring core twice.

- 11) Attach AC input cable ⑮ and output cable ⑯ on the undersurface of table using supplied staple ⑭ . At this time, take care not to cross the input- and output-cables ⑮⑯ .

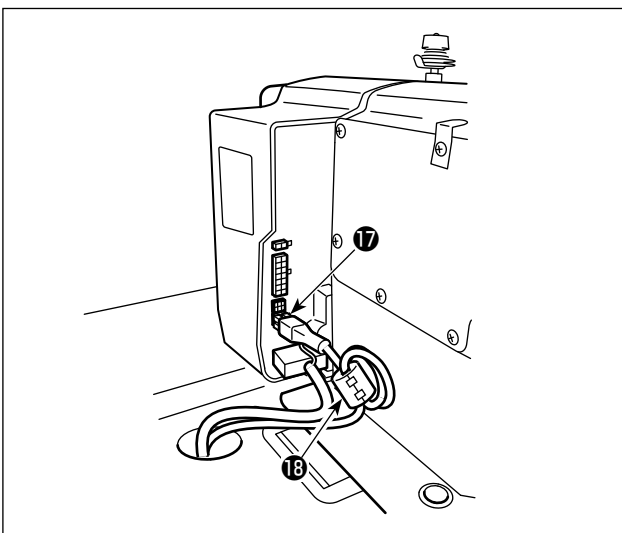

- 12) Install ring core ⑱ .

For one ring core ⑱ , clamp the pedal sensor cable ⑰ after winding the cable round the torus of the ring core three times.

4. Installing the reactor box [Only for the EU type models]

* For the EU-type models, install the reactor box that is supplied with the sewing machine.

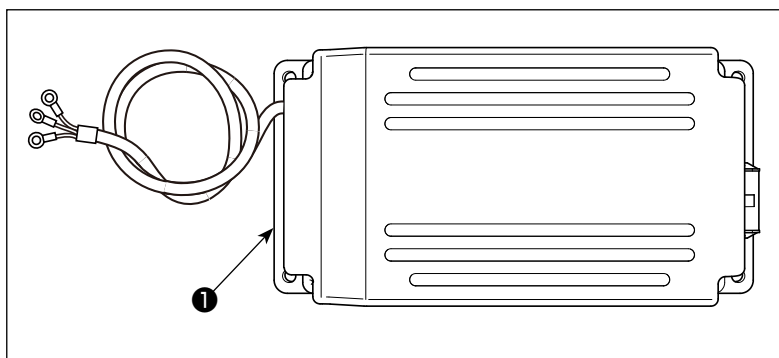

1) Remove the reactor box ❶ from the accessory box.

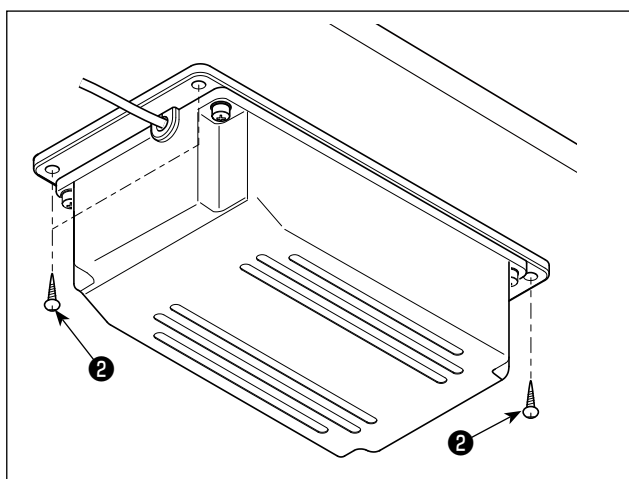

2) Remove the wood screws ❷ from the accessory bag and install the reactor box under the table.
(4 screw tightening locations)

3) Refer to the figure to install the reactor box ❶ .

