

SPECIFICATIONS

Model name	DX-01
Specifications	Fully digital
Application	Medium-weight
Lubrication	Fully dry (JUKI Grease A applied only to the surface)
Maximum sewing speed	4,000sti/min*1
Feed method	Intermittent belt feed with a direct-drive stepping motor
Maximum stitch length / Maximum top feed amount	9 mm
Thread trimming method	Double-edge rotary system
Needle bar stroke	30.7 mm
Needle	DB x 1 (#11) #9~#14 DP x 5 (#11) #9~#14 (Compliant with European specifications)
Thread take-up	Link-type thread take-up lever
Hook (Pre-installed at the factory)	Dry hook
Presser foot lift amount	Auto presser lifter: 1st stage 8.0 mm (0.1 to 10.0 mm*2) 2nd stage 10.0 mm (2.0 to 13.5 mm*2)
Number of sewing patterns that can be stored	99 patterns + 20 cycle patterns
(Polygonal stitching) Number of steps that can be stored	30 steps
Hand switch	Standard with 3-button system (Factory settings: reverse feed stitching, one-touch changeover, one-stitch correction)
Maximum stitch length	9mm
Soft-start function	Provided as standard
Automatic reverse feed stitching function	Provided as standard
Auto presser foot lifter device	Provided as standard (Motor type)
Bobbin thread winder	Built in the top of machine head (provided with a bobbin thread retaining plate)
JUKI Two-way communication function	Support through the USB・JUKI SMART App
Machine head size	517 mm x 178 mm (Distance from needle to machine arm: 310 mm)
Machine head drive	Compact AC servomotor: 400W, directly connected to the main shaft (direct-drive system)
Power supply / Power consumption	600VA
Net weight	48.6Kg

*1 0.00~5.00mm 4000sti/min, 5.01~6.50mm 3000sti/min, 6.51~9.00mm 2000sti/min
*2 Adjustable via panel. The height of the knee lifter lever is based on the 2nd stage setting.

WHEN YOU PLACE ORDERS

Please note when placing orders, that the model name should be written as follows:

Machine head

DX-01DS

Oiling classification	Sewing application	Code
Fully dry	Medium-weight	DS

Electrical control box

SC957A□

Power supply	Code
3-phase 200-240 V	D
Single-phase 200-240 V	K
CE 200-240 V	N

JUKI SUSTAINABLE PRODUCTS

Products complied with JUKI SUSTAINABLE PRODUCTS Standard (JUKI own standard)

The products are paying attention to environmental impact reduction, better working environment and helping create smart factory.

► <https://www.juki.co.jp/en/sustainability/society/technology.html>

JAB MS CM001

JSA EMS ISO14001 JSAE389

Registered Organization: JUKI CORPORATION Head Office

The Scope of the Registration: The activities of research, development, design, sales, distribution, and maintenance services of industrial sewing machines, household sewing machines and industrial robots, etc., including sales and maintenance services of data entry systems.

DX-01

1-Needle Lockstitch Sewing System with Electronic Belt Feed

- Direct-Drive

Fully digital

Fully dry

Data Communication (USB&NFC)

- The World's First!

 6-belt feed-assist mechanism
- Smooth feed adjustment and trial stitching with no unraveling. Significantly reduced setup times.
- Comes with the knee presser lifting lever as standard. Familiar operation with new convenience.



Supporting and guiding the craftsmanship of masters

Featuring JUKI's latest technology — **the 6-belt feed-assist mechanism**



The World's First! 6-belt feed-assist mechanism

This is the world's first sewing machine designed to assist operators with fabric handling. The six belts precisely maintain the optimal feed amount, ensuring the smooth sewing of curved seams with easing and a gentle touch on the fabric. The DX-01 dramatically boosts productivity.

Smooth feed adjustment and trial stitching with no unraveling Significantly reduced setup times

Minimize seam ripping time with the "Threadless Preview". With help from the intuitive screen, sensory adjustments to the left/right curves and up/down feed amounts are as easy as turning a dial. The sewing direction can also be checked from instantly graspable illustrations on display.

Comes with the knee presser lifting lever as standard Familiar operation with new convenience

The ever-popular knee presser lifting lever, LED hand light, and reverse-feed stitching lever are now joined by reduced vibration operation and an active suspended ruler that eliminates the need for repositioning with every pattern change.

Improved productivity

The World's First! "6-belt feed-assist mechanism"

The World's First! 6-belt feed-assist mechanism

Curved processes like easing are completed efficiently and beautifully

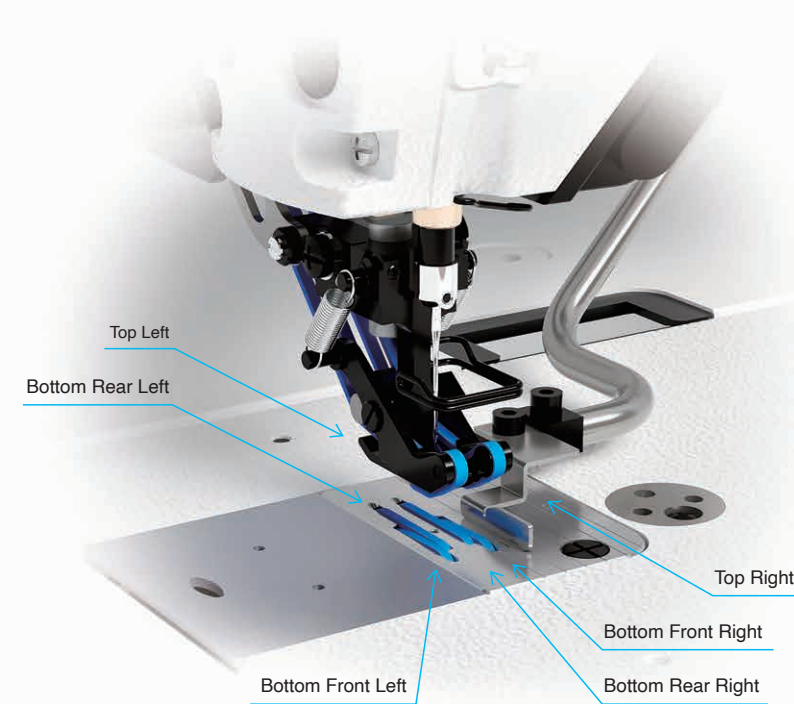

JUKI developed the 6-belt feed-assist mechanism as a unique "fabric handling" assist technology*1 to streamline work and boost productivity. Automatic calculation and precise control of the optimal feed with six belts arranged above and below ensure the easy handling of difficult processes. The operation is achieved fast and simply by guiding the fabric by hand.

Example of use

Easing

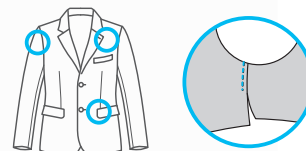

Curve

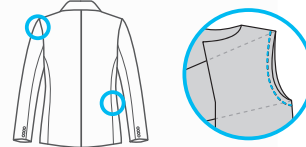

* 1 J-DX F Technology

JUKI Digital transformation Feed Technology

JUKI's feed technology enables independent control of the feed mechanism and needle bar drive. This technology is the foundation of the 6-belt feed-assist mechanism and new value offered by the DX-01.

Stable feed force and stitch quality

Stable feed force and consistent stitching even at high speeds

The upper and lower belts securely grip even hard-to-feed materials, ensuring strong feed force during high speeds and reducing defects such as skipped or jumping stitches.

Feed force comparison

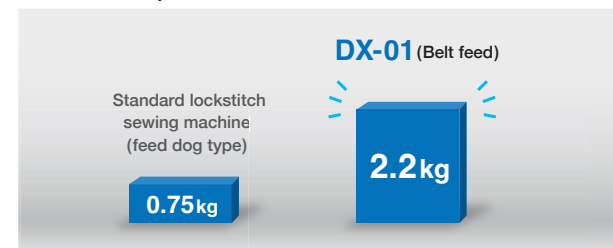

[Reference] 4,000 rpm, presser foot pressure: 3 kg

Presser foot joint

Versatile design:
multiple functions in a single machine

With its interchangeable top feed belt and standard presser foot, the machine can also be used as a conventional bottom feed sewing machine. The wide-ranging processes handled ensure high rates of machine utilization.

Stitch number switching

Seamless continuous sewing
with automatic step switching

Step switching supports both manual operation via the hand switch and automatic operation based on a preset number of stitches. Sewing continues without feed stoppage during step changes.

Improved setup efficiency

Smooth feed adjustment and trial stitching with no unraveling.
Significantly reduced setup times.

Innovative concept Threadless Preview

Reduced seam ripping during trial stitching

High-precision trial stitching with a minimal risk of fabric damage is achieved by operating only the feed mechanism*1 while securely gripping the fabric between the upper and lower belts. This approach reduces the time spent on seam ripping, an operation that used to take up to three times longer than the actual sewing.

Setup time comparison

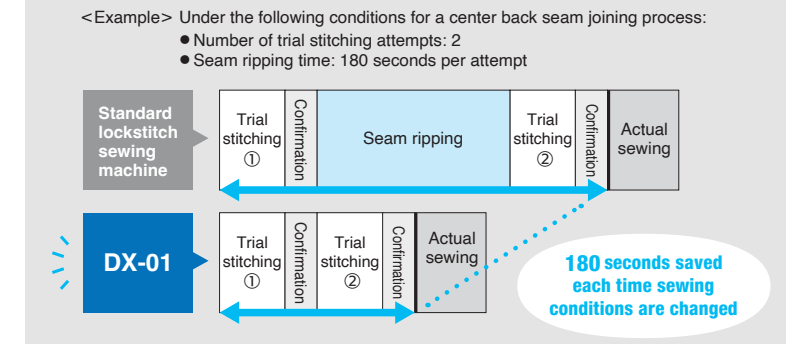

[Reference] With a process time of 30 seconds, this is equivalent to producing 6 pieces

Setting the belt feed amount Ratio-based input for setting the optimal feed amount

Configure the optimal feed amount simply and automatically by entering the differential value between the upper/lower and left/right belts as a ratio (%) relative to the set stitch length. Fine-tuning the feed with the [-] and [+] buttons is as easy and intuitive as using a dial. The on-screen illustration changes in real time according to the input values.

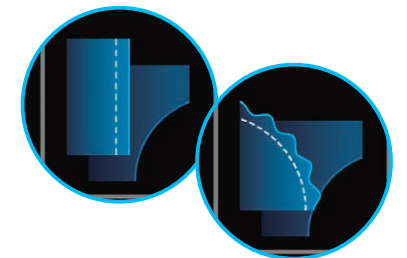
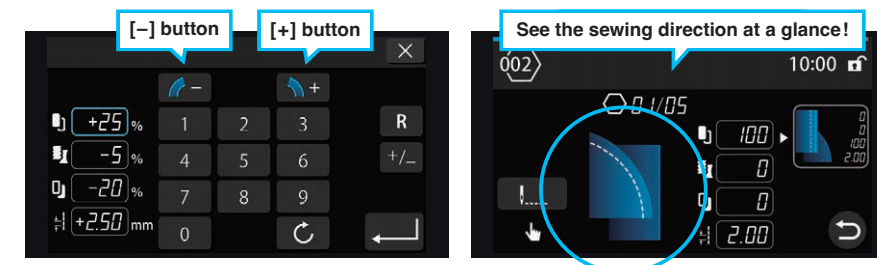

Example of an illustration pattern change

Preset pattern

Customization of preregistered patterns

Common patterns like "sleeve attachment" and "hood" are preregistered, allowing you to customize the preset values according to your exact requirements.

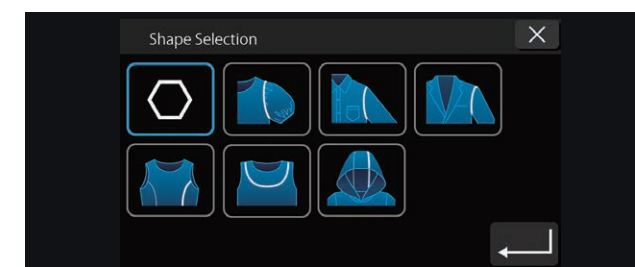

Two pattern reversal functions

One-touch reversal of left/right sewing patterns

There's no need for pattern re-entry when sewing the left side based on the right-side pattern: use function ① "Reverse sewing order" if the material position remains unchanged, or function ② "Reverse top and bottom feed" if the material is flipped upside down. (The differential amount must be readjusted.)

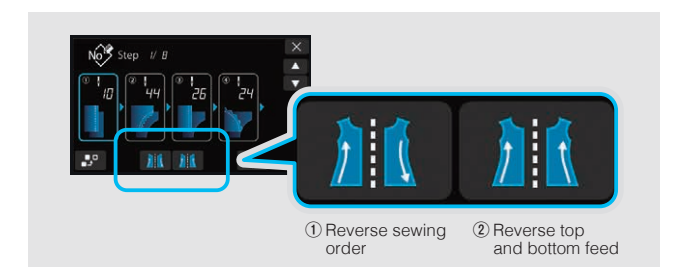

Operator-friendly design

Comes with the knee presser lifting lever as standard. Familiar operation with new convenience.



Knee presser foot lifting lever
Stay focused on your hands

When sewing curves or making fine position adjustments, you can precisely control the height of the presser foot without taking your hands off the fabric.



A standard feature you'll appreciate

Auto-Positioning Suspended Ruler
Automatic ruler alignment

The ruler position automatically shifts left or right to match the registered sewing width for each pattern number. Begin sewing immediately after switching patterns.



3-Custom switch system
Keep frequently used functions right at your fingertips

Freely assign any of 22 available functions (pattern step switching, etc.) to the three hand switches. Set the functions through simple touch panel control.

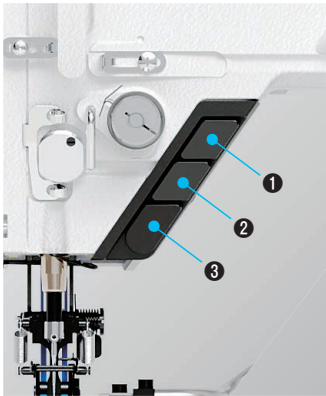

- 1 One stitch correction switch
- 2 One-touch changeover switch
- 3 Reverse feed stitching switch

Low vibration
Reduced fatigue from vibration

Machine vibration reduced by 23%* by eliminating feed dog rotation. Improves operator comfort.
(* Based on vibration displacement comparison with our previous model.)



Vibration 23% reduction

LED hand light
Clear view of the needle area with reduced eye strain

Three light colors and six brightness levels provide optimal visibility around the needle area for reduced eye fatigue.

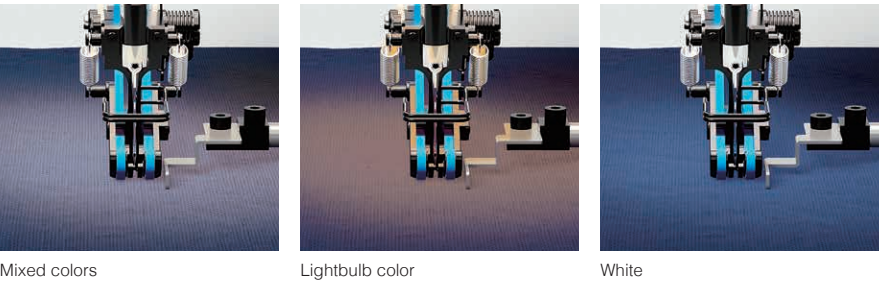

Mixed colors

Lightbulb color

White

Lubrication
Fully dry
No oil staining issues

JUKI's proprietary lubrication control technology*2 enables oil-free operation of the needle bar, thread take-up lever, and hook area. Oil stains on sewn products are a thing of the past.

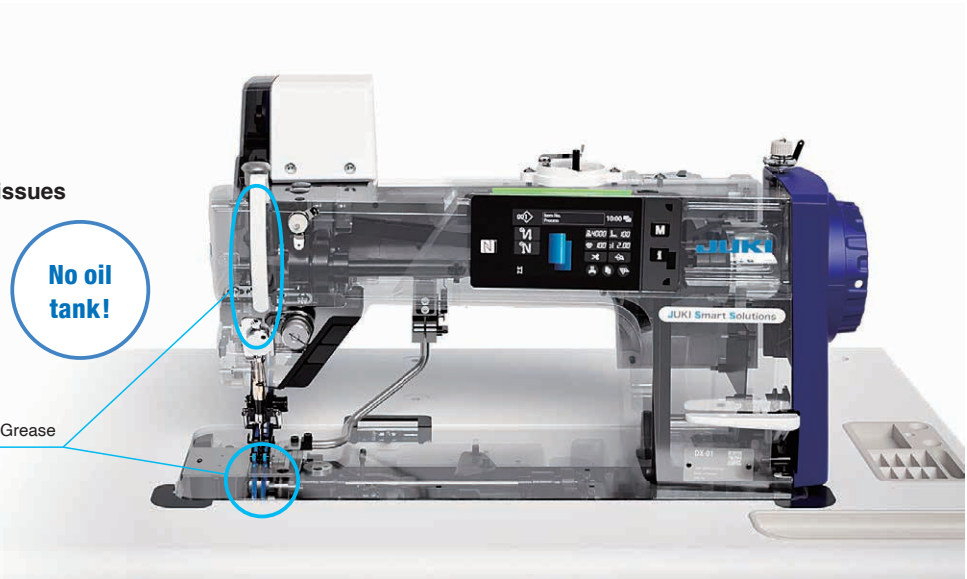

No oil tank!

Grease

* 2 J-Fine Glide Technology

JUKI High-speed Glide technology with fine Clearance

The high-precision design and special surface treatments of the components reduce wear and extend the operation life by enabling oil-free lubrication.

Easy-to-understand main screen
Sewing conditions "right now" at a glance

Check the current sewing status and frequently adjusted settings (presser foot pressure, bobbin thread tension, stitch length, etc.) instantly, at a glance. Switch between two screen display options to suit your preference.

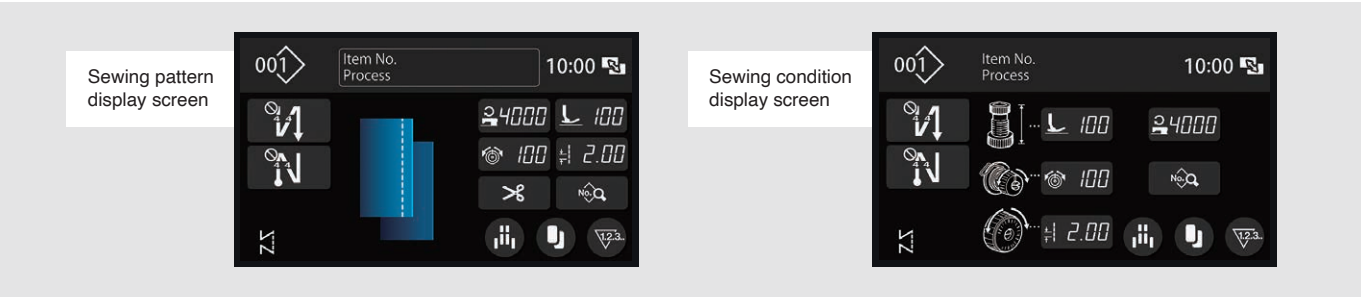

Sewing pattern display screen

Sewing condition display screen

Option

Optional gauge name assembly	Part number
<ul style="list-style-type: none">● Compact presser foot The compact presser foot design, shorter than the standard type, allows for easier sewing of small curves and improved fabric handling.	40308680
<ul style="list-style-type: none">● Presser foot spring A You can also prevent puckering by replacing the presser foot spring and increasing the presser foot pressure. * The ability to adjust the left and right feed amounts ensures excellent straight stitching.	40172404
<ul style="list-style-type: none">● Separation plate	MAZ061000A0
<ul style="list-style-type: none">● Fabric guide (right) (Right guide shaft, mounting screw, right fabric guide)	40309119
<ul style="list-style-type: none">● Fabric guide (left) (Left guide shaft, mounting screw, left fabric guide)	40309120
<ul style="list-style-type: none">● Stitch guide (right) (Right guide shaft, mounting screw, right stitch guide) The guide extends to the front of the presser foot, allowing for narrower stitch width adjustments right up to the needle entry.	40309123



Compact presser foot

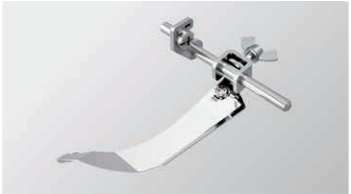

Stitch guide (right)