

PS-910HS-6055 (for decorative stitching)

PS-910AS-6055 (for air bag)

Machine Head Rotation Pattern Seamer

Sewing area 600mm(X) × 550mm(Y)

Your Ingenuity creates opportunities for Automation



Please watch the video clip



YouTube



Facebook



JUKI official site



List of optional items

PS-910AS6055ZKW

Machine head rotation mechanism helps achieve high-quality seams uniformly in every sewing direction

JUKI's unique synchronization technology controls the machine head, hook and feed mechanism, thereby creating the most favorable seams. In case of continuous circumference sewing, the sewing machine constantly detects the direction of sewing. As a result, consistent-quality seams are produced regardless of the direction of sewing.

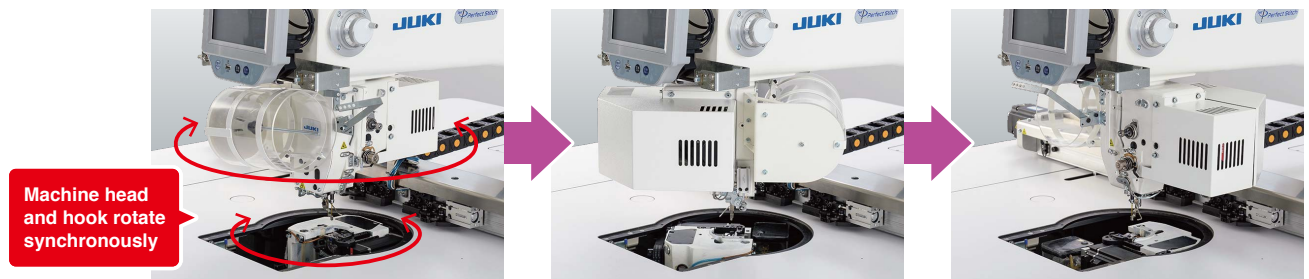

Machine head and hook rotate synchronously

Adopts a full-rotary double-capacity hook

The same full-rotary double-capacity hook as the PS-800 series is used. It provides stable sewing and reduces the time required for changing the lower thread.



Active tension

Market-prov active tension has been introduced to the needle thread tension controller. With the active tension, pinpoint changes in the needle thread tension during sewing are enabled. The needle thread tension, therefore, can be set in conjunction with the material thickness and can be corrected according to the direction of sewing on a stitch-by-stitch basis through the operation panel.



Patterns are identified by means of RFID/Barcode reader to enable automatic reading of sewing data

Sewing patterns are automatically identified by means of RFID/ Barcode reader to automatically call up the relevant sewing program, thereby starting sewing quickly.

RFID (radio frequency identification)

It is the technology to read and write data saved on IC chips through wireless non-contact transfer of radio frequency waves and is used to identify and manage products.



Intelligent Medium-Presser Foots

It is possible to change the intermediate presser height at its lower dead point steplessly during sewing. This feature is particularly effective when sewing multi-layered portions of material. Since the material is stably held by the intermediate presser, sewing troubles such as stitch skipping and thread breakage are prevented.

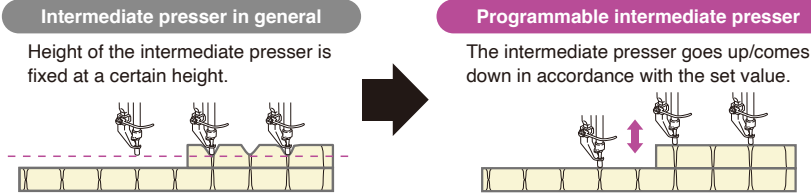

Operation panel

The sewing pattern data format are supports DXF, AI, PLT, and DST. Sewing pattern data in these formats are widely used in many sewing plants. As a result, the operation panel is able to use the customers' existing sewing pattern data immediately. As many as 999 sewing patterns can be saved on the large-capacity memory of the operation panel. (Editing software is included with the accessory.)



Operation switch

The operation switch operates up and down, so the operator It can be adjusted to a position where it is easy to work. Reduces operator fatigue when sewing for long periods of time.

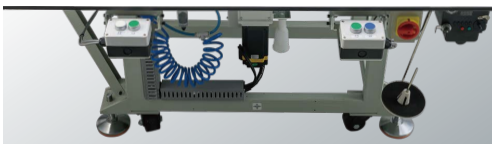

PS-910AS6055ZKW (PS-910HS has one switch.)

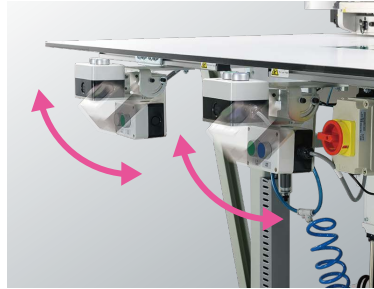

Optional device

Option	Parts No.	Features	Remarks
BK-10 Bobbin changer device	40270689	Provided that a spare bobbin case which is loaded with a bobbin fully wound with thread is set before starting sewing, automatic replacement of bobbin cases is enabled to spare the operator the trouble of changing bobbin cases by hand, thereby increasing production efficiency.	As many as seven spare bobbins can be placed in the cassette.
Barcode reader unit	40289310	Sewing pattern that matches the template can be called up when the barcode on the template is read by the barcode reader. (Air bag specifications are standard.)	
Needle thread clamp unit	40289313	The needle thread clamp unit prevents the needle thread and bobbin thread from becoming entangled at the start of the next sewing by grasping the tip of the needle thread after thread trimming.	

SPECIFICATIONS

Model name	PS-910HS-6055ZKZ PS-910HS-6055ZKW	PS-910AS-6055ZKZ PS-910AS-6055ZKW
Sewing area	600 mm × 550 mm*1	
Max. sewing speed	3,000 sti/min*2	
Lubrication	Semi-dry	
Feeding type	Screw drive	
Stitch length	0.5 - 12.7 mm	
Hook	Full-rotary double-capacity hook	
Lift / Stroke of intermediate presser	Lifting amount: 20 mm / Stroke: Standard 4 mm	
Variable lower position of the intermediate presser	0 - 9 mm	
Needle	DB × 17 #21 (#19~#21)	DB × 17 #23 (#23~#25)
Template recogniser	RFID: 6055ZKZ Barcode: 6055ZKW	RFID: 6055ZKZ Barcode: 6055ZKW
Storage of pattern data in the memory	Max. 999 patterns (5,000,000 sti/pattern)	
Program input mode	USB	
Weight	552Kg (ZKZ)	
Dimensions	1,753mm (W) × 1,410mm (L) × 1,524mm (H)	

*1 The X-direction can be extended up to 800 mm.

* Sewing area: 800mm(X) × 550mm(Y): PS-910HS6055ZK*/X88032, PS-910AS6055ZKW/X88032

*2 sti/min is the abbreviation for "stitches per minute"

WHEN YOU PLACE ORDERS

Please note when placing orders, that the model name should be written as follows:

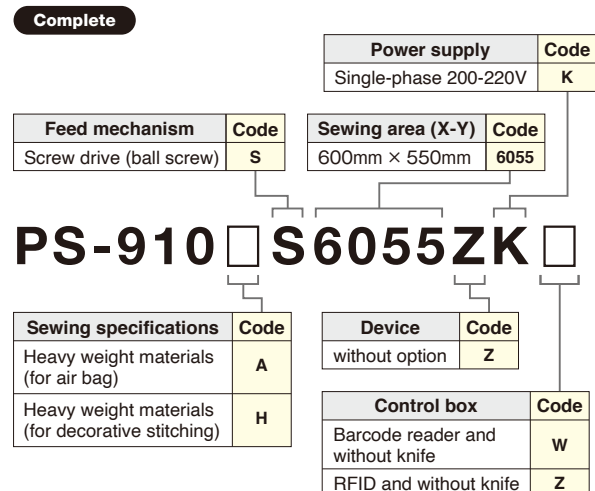

JUKI

<https://www.juki.co.jp/en>

JUKI CORPORATION
SEWING MACHINERY & SYSTEMS BUSINESS UNIT

2-11-1, TSURUMAKI, TAMA-SHI, TOKYO 206-8551, JAPAN
PHONE: (81) 42-357-2383 FAX: (81) 42-357-2274

JUKI ECO PRODUCTS

PS-910HS-6055 and PS-910AS-6055 are eco-friendly products which complies with JUKI ECO PRODUCTS standards for protecting the environment.



● The sewing machine complies with the "Juki Group Green Procurement Guidelines" on the use of hazardous substances, which is stricter than other restrictions, such as those of the RoHS Directive.

For details of JUKI ECO PRODUCTS, refer to: <https://www.juki.co.jp/en/company/eco>

*The RoHS Directive is an EU Directive limiting the use of 6 hazardous substances (lead, hexavalent chromium, mercury, cadmium, PBB and PBDE) in electrical and electronic equipment. The Juki Green Procurement Guideline is the voluntarily established criteria to eliminate not only the aforementioned six substances, but also other ones which also adversely affect the environment.



MS CM001



EMS ISO14001 JSAE399

JUKI TECHNOSOLUTIONS CORPORATION

NAGOYA OFFICE

1-1801, KAMIYASHIRO, MEITO-KU, NAGOYA-SHI, AICHI 465-0025 JAPAN
PHONE: (81) 52-772-6412 FAX: (81) 52-772-6420

● Specifications and appearance are subject to change without prior notice for improvement. ● Read the instruction manual before putting the machine into service to ensure safety.

● This catalogue prints with environment-friendly soyink on recycle paper. ● Paper from responsible sources FSC™ C001712

FEBRUARY, 2024 Printed in Japan(TN)