

PS-800SB-3830 (Light weight materials) PS-800HB-3830 (Heavy weight materials)

Pattern Seamer **Sewing area** 380mm(X) × 300mm(Y)

Your Ingenuity creates opportunities for Automation

The machine head adopts the oilfree lubrication technology with supporting various sewing and materials

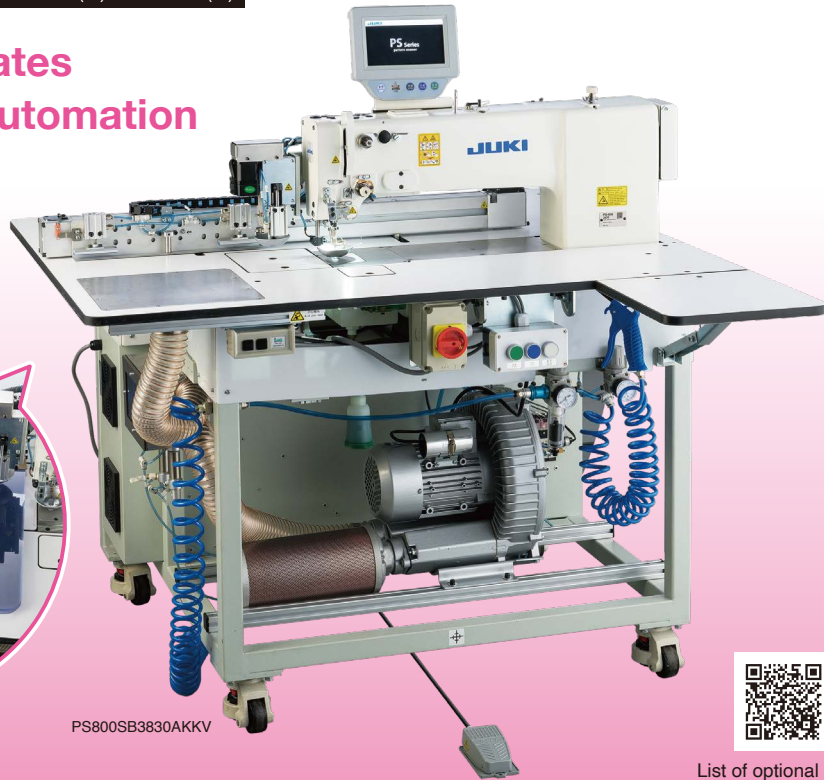

PS800SB3830AKKV

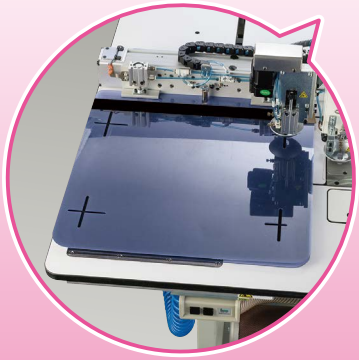

Please watch the video clip



YouTube



List of optional items



Facebook

Rotary twin knives (upper and lower type)

〈PS-800SB3830AKKV, PS-800SB3830AKK〉

The rotary twin knives (upper and lower type) can cut curved lines with the original soft texture of the fabric without black burning the material or unpleasant odor caused by the laser cutter.



Adopts a full-rotary double-capacity hook

The same full-rotary double-capacity hook as the PS-800 series is used. It provides stable sewing and reduces the time required for changing the lower thread.



Fabric Vacuum Function 〈PS-800SB3830AKKV, PS-800SB3830ZKZV〉

Easy to set the sewing materials since Vacuum device work under the table. It is help to set softy/light fabric.

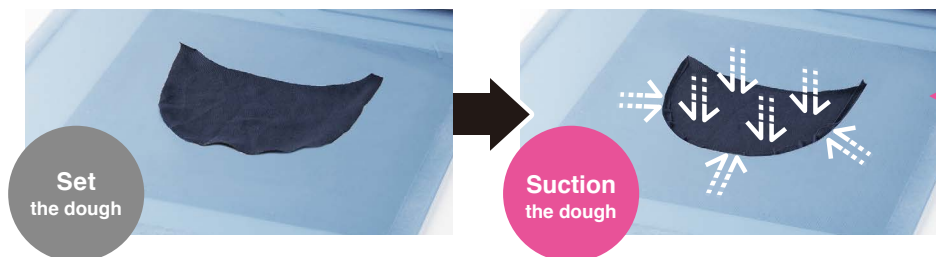

Set the dough

Suction the dough

Vacuum Unit

Operation panel

The sewing pattern data format are supports DXF, AI, PLT, and DST. Sewing pattern data in these formats are widely used in many sewing plants. As a result, the operation panel is able to use the customers' existing sewing pattern data immediately. As many as 999 sewing patterns can be saved on the large-capacity memory of the operation panel. (Editing software is included with the accessory.)



Patterns are identified by means of RFID/Barcode reader to enable automatic reading of sewing data

Sewing patterns are automatically identified by means of RFID/Barcode reader to automatically call up the relevant sewing program, thereby starting sewing quickly.

RFID
(radio frequency identification)

It is the technology to read and write data saved on IC chips through wireless non-contact transfer of radio frequency waves and is used to identify and manage products.

Intelligent Medium-Presser Foots

It is possible to change the intermediate presser height at its lower dead point steplessly during sewing. This feature is particularly effective when sewing multi-layered portions of material. Since the material is stably held by the intermediate presser, sewing troubles such as stitch skipping and thread breakage are prevented.

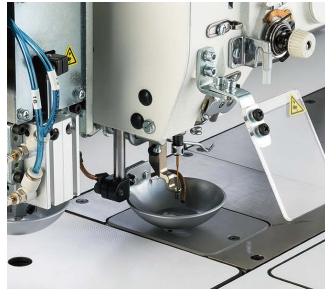
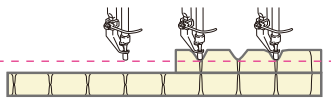

Plate presser foot

Intermediate presser in general

Height of the intermediate presser is fixed at a certain height.



Programmable intermediate presser

The intermediate presser goes up/comes down in accordance with the material thickness.

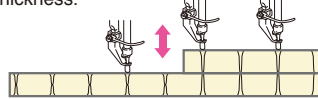

Operation switch

The Operation switch operates up and down, so the operator It can be adjusted to a position where it is easy to work. Reduces operator fatigue when sewing for long periods of time.



Operation switch



Operation switch with variable mounting plate

SPECIFICATIONS

Model name	PS-800SB-3830AKKV	PS-800SB-3830AKK	PS-800SB-3830ZKZV	PS-800SB-3830ZKZ	PS-800HB-3830ZKZ
Sewing specifications	Light weight materials				Heavy weight materials
Sewing area	380mm x 300mm				
Max. sewing speed	3,000 sti/min*1 (at the time of delivery: 2,800 sti/min)				3,000 sti/min*1 (at the time of delivery: 1,800 sti/min)
Lubrication	Semi-dry (Needle bar: dry)				
Fabric vacuum function	Standard	—*2	Standard	—*2	—*2
Knife	Rotary twin knives (upper and lower type)		Non knife		
Hook	Full-rotary double-capacity hook				
Lift / Stroke of intermediate presser	Lifting amount: 20mm / Stroke: Standard: 4mm				
JaNets device	Retrofittable				
Dimensions	1,200mm (W) x 1,020mm (L) x 1,440mm (H)				
Template recogniser	RFID				
Template recogniser for barcode model	PS-800SB-3830AKVV	PS-800SB-3830AKV	PS-800SB-3830ZKWV	PS-800SB-3830ZKW	PS-800HB-3830ZKW

*1 sti/min is the abbreviation for "stitches per minute" *2 Option device can be retrofitted. (Fabric vacuum function: No.40286900)

WHEN YOU PLACE ORDERS Please note when placing orders, that the model name should be written as follows:

Feed mechanism	Code	Sewing area (X-Y)	Code	Power supply	Code
Belt drive	B	380mm x 300mm	3830	Single-phase 200-220V	K

PS-800 **B** **3830**

Sewing specifications	Code	Knife	Code	Control box	Code	Vacuum device	Code
Light weight materials	S	Rotary twin knives (upper and lower type)	A	with RFID and knife	K	with vacuum	V
Heavy weight materials	H	Non knife	Z	Barcode reader and with knife	V	without vacuum	—
				Barcode reader and without knife	W		
				with RFID and without knife	Z		

JUKI

<https://www.juki.co.jp/en>

JUKI CORPORATION
SEWING MACHINERY & SYSTEMS BUSINESS UNIT

2-11-1, TSURUMAKI, TAMA-SHI, TOKYO 206-8551, JAPAN
PHONE: (81) 42-357-2370 FAX: (81) 42-357-2274

The AW-3S is an eco-friendly product which complies with JUKI ECO PRODUCTS standards for protecting the environment.



● The sewing machine complies with the "Juki Group Green Procurement Guidelines" on the use of hazardous substances, which is stricter than other restrictions, such as those of the RoHS Directive.
For details of JUKI ECO PRODUCTS, refer to: <https://www.juki.co.jp/en/company/eco>
*The RoHS Directive is an EU Directive limiting the use of hazardous substances (lead, hexavalent chromium, mercury, cadmium, PBB and PBDE) in electrical and electronic equipment.
*The Juki Green Procurement Guideline is the voluntarily established criteria to eliminate not only the aforementioned six substances, but also other ones which also adversely affect the environment.



Registered Organization:
JUKI CORPORATION Head Office
The Scope of the Registration: The activities of research, development, design, sales, distribution, and maintenance services of industrial sewing machines, household sewing machines and industrial robots, etc., including sales and maintenance services of data entry systems.

JUKI TECHNOSOLUTIONS CORPORATION

NAGOYA OFFICE

2039-1, SHIMOI, SHIMOI-MACHI, OWARIASAHI-SHI, AICHI 488-0052, JAPAN
PHONE: (81) 561-56-1082 FAX: (81) 561-56-0830

● Specifications and appearance are subject to change without prior notice for improvement. ● Read the instruction manual before putting the machine into service to ensure safety.

● This catalogue prints with environment-friendly soyink on recycle paper. ● Paper from responsible sources FSC™ C001712

NOVEMBER, 2023 Printed in Japan(TN)