

SPECIFICATIONS

Model name	Without automatic thread trimmer	LZ-2280BA	LZ-2280BB	LZ-2284B	LZ-2287B
	With automatic thread trimmer	—	—	LZ-2284B-7	—
Stitch system		Standard zigzag	Standard wider zigzag	Standard / 3-step zigzag	3-step zigzag / scallap
Stitch pattern					
Max. sewing speed		5,000 sti/min*			
Max. zigzag width		5 mm	8 mm	5 mm (standard) 10 mm (3-step)	10 mm
Max. feeding amount		2.5 mm	5 mm	2.5 mm	2.5 mm
Lift of the presser foot		By hand: 5.5 mm, By knee: 10 mm			
Hook		DP hook (with titanium-treated inner hook)			
Thread take-up		Rotary type			
Lubrication		Fully automatic			
Lubricating oil		JUKI New Defrix Oil No.1 (equivalent to ISO VG7)			
Needle (at the time of delivery)		134SUK (Nm70)			
Needle position changing mechanism		Provided as standard			
Reverse feed stitching mechanism		Provided as standard			
Needle throw pattern cam		Triangular cam		Grooved cam	

* sti/min is the abbreviation for "stitches per minute"

WHEN YOU PLACE ORDERS

Please note when placing orders, that the model name should be written as follows:

● LZ-2280B series (without automatic thread trimmer)

LZ228 0B

Type	Code	Automatic reverse feed function	Code	Type	Code
Standard wider zigzag (with a gauge for 5mm zigzag width)	0BA	with automatic reverse feed function	0B	Single-phase 100-120V	A
Standard wider zigzag (with a gauge for 8mm zigzag width)	0BB			3-phase 200-240V	D
Standard/3-step zigzag	4B			Single-phase 200-240V	K
Standard/3-step zigzag (with tape attaching)	4BT			Single-phase 200-240V (CE)	N
3-step zigzag / scallap	7B				

● LZ-2280B-7 series (with automatic thread trimmer)

LZ2284B7

Type	Code	Wiper and automatic reverse feed function	Code	Auto-lifter	Code	Power supply	Code	
Standard / 3-step zigzag	4B	Wiper	Automatic reverse feed function	Code	Not provided	Single-phase 100-120V	A	
		Not provided	Provided	0B	Provided	AK	3-phase 200-240V	D
		Provided	Provided	WB			Single-phase 200-240V	K
						Single-phase 200-240V (CE)	N	

LZ-2280B Series

High-speed, 1-needle, Lockstitch, Zigzag Stitching Machine

The sewing machine stably produces softly finished seams with a low tension applied to the thread.



LZ-2284B7WBAK

JUKI ECO PRODUCTS The MF-3620 is an eco-friendly product which complies with JUKI ECO PRODUCTS standards for protecting the environment.

● The sewing machine complies with the "Juki Group Green Procurement Guidelines" on the use of hazardous substances, which is stricter than other restrictions, such as those of the RoHS Directive.

For details of JUKI ECO PRODUCTS, refer to: <https://www.juki.co.jp/en/company/eco>

*The RoHS Directive is an EU Directive limiting the use of 6 hazardous substances (lead, hexavalent chromium, mercury, cadmium, PBB and PBDE) in electrical and electronic equipment. The Juki Green Procurement Guideline is the voluntarily established criteria to eliminate not only the aforementioned six substances, but also other ones which also adversely affect the environment.

MS CM001 ISO14001 JSAE389

Registered Organization: JUKI CORPORATION Head Office
The Scope of the Registration: The activities of research, development, design, sales, distribution, and maintenance services of industrial sewing machines, household sewing machines and industrial robots, etc., including sales and maintenance services of data entry systems.

JUKI
JUKI CORPORATION
SEWING MACHINERY & SYSTEMS BUSINESS UNIT

2-11-1, TSURUMAKI, TAMA-SHI,
TOKYO 206-8551, JAPAN
PHONE: (81) 42-357-2370
FAX: (81) 42-357-2274
<https://www.juki.co.jp/en>

* Specifications and appearance are subject to change without prior notice for improvement.
* Read the instruction manual before putting the machine into service to ensure safety.
* This catalogue prints with environment-friendly soyink on recycle paper.
* Paper from responsible sources FSC™ C001712

AUGUST, 2023 Printed in Japan(TN)

Standard model of the zigzag stitching machines

High-speed, 1-needle, Lockstitch, Zigzag Stitching Machine

LZ-2280B Series

Sewing with a low thread tension achieves soft seams with improved stability.

LZ-2280B Series

- 1 The electrical control box that is integrated with the machine head is adopted for the zigzag stitching machine.
- 2 Seam quality has been improved to stabilize the thread tension (to decrease irregular stitches) and increase the efficiency of feed.
- 3 This model further stabilizes the low-tension sewing feature that has been achieved by the predecessor model.
- 4 The improved feed mechanism enhances the efficiency of feed, thereby enabling stable sewing.
- 5 The sewing machine smoothly sews the material at its multi-layered portions.



Integrated electrical control box

The LZ-2280B Series sewing machine has adopted the machine head integrated with the electrical control box and motor. In addition, the operation panel is also integrated into the machine head, thereby facilitating set-up of the sewing machine.

Direct motor

Direct drive system that is directly coupled with the main shaft is adopted. The direct motor provides increased energy savings and improved responsiveness, thereby achieving the improved features of the sewing machine such as enhanced start-up and stopping accuracy.

USB port

The sewing machine is provided as standard with a USB port that can be used for charging smartphones, etc.

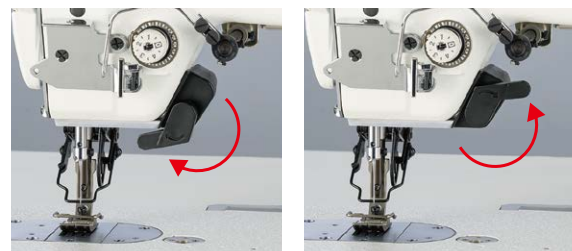

Touch-back switch

Since the electrical control box is also integrated into the sewing machine head of the model without thread trimmer, the touch-back switch, which could not be added to the sewing machine retrofitted with a commercially-available direct drive motor, is now provided as standard. Since this touch-back switch is of the rotary type, the operator is allowed to carry out sewing work with the material placed closer to the switch.

Operation panel

For the conventional LZ-2280B Series sewing machine without thread trimmer, condensation stitch and overlapped stitch cannot be set on the operation panel. Now, it comes with the machine head integrated electrical control box to enable setting of condensation stitch and overlapped stitch on the operation panel. As a result, jump sewing process and label sewing process can be carried out with ease.

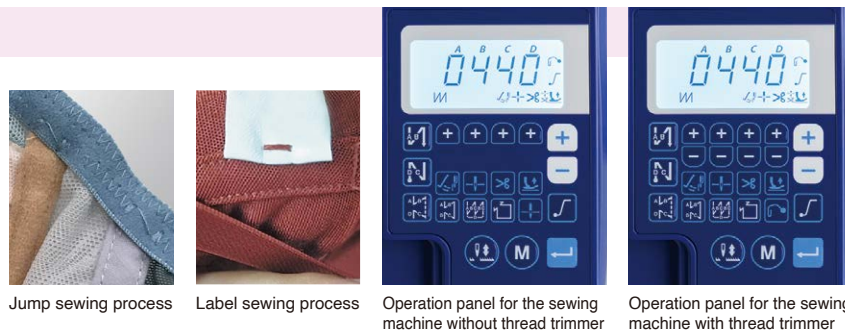

LED hand light Reduction of the operator's fatigue

The LED light is provided as standard under the machine arm jaw. The sewing machine is installed with the color tone variable type LED light that permits adjustment of the daytime white color and light bulb color. The color tone of the LED light can be adjusted in accordance with the sewing product or environment. This helps improve workability and reduce eye fatigue.

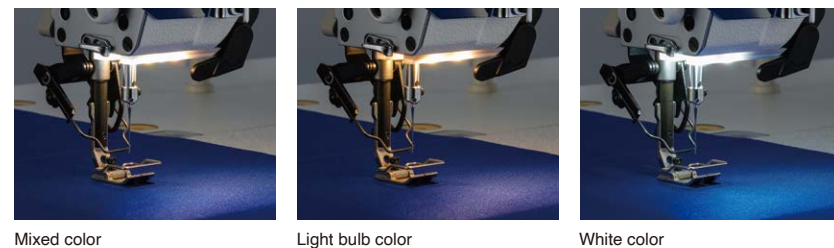

JUKI's unique thread trimming mechanism (for LZ-2284B-7)

JUKI-specific loop spreading-structure knife sliding system enables thread trimming without fail whether needle throws to the right or the left.

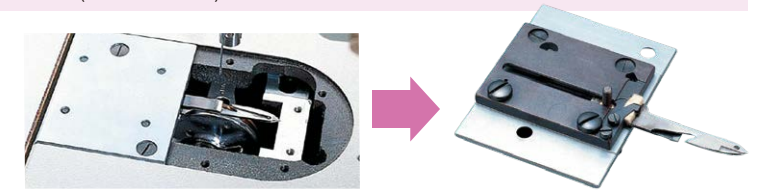

Maintenance

The adjustable range of the feed mechanisms has been widened, thereby upgrading the machine's responsiveness to materials

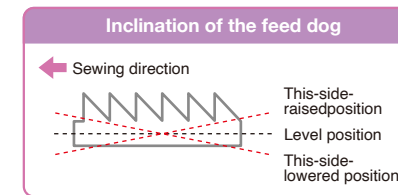

The feed mechanism has been improved by widening the adjustable range of the height and inclination of the feed dog. The feed locus has been optimized while placing great emphasis on the feed locus at the moment the needle penetrates the material to form a stitch. The weight of the feed mechanism has been reduced by using parts most of which are made of aluminum material. This facilitates sewing of overlapped sections of material that have to be securely held between the presser foot and the feed dog during sewing.

Adjustment for various feed timings

Marker lines engraved on the face plate and the pictorial indication facilitate adjustment of the needle-to-feed hook timing.

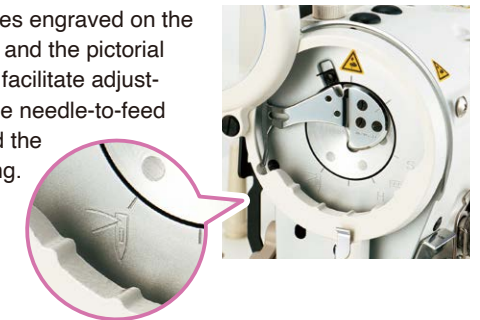

Adjustment of oil quantity in the hook

Oil feeding path of the LZ-2280A Series has been reviewed to enable feeding of consistent quantity of oil.

Standard zigzag stitching machine

Standard / Standard wider zigzag

High-speed, 1-needle, Lockstitch, Zigzag Stitching Machine

LZ-2280B

The standard zigzag stitching machine creates softly finished seams. The needle rocking mechanism is provided with a triangular cam which helps produce beautiful seams with consistency.



Two kinds of gauges can be selected in accordance with the application of the machine: an A-type gauge with a zigzag width of 5 mm, and a B-type gauge with a zigzag width of 8 mm.

Zigzag width: 5 mm

High-speed, 1-needle, Lockstitch, Zigzag Stitching Machine

LZ-2280BA

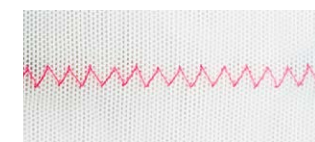

Zigzag width: 8 mm

High-speed, 1-needle, Lockstitch, Standard wider zigzag stitching machine

LZ-2280BB

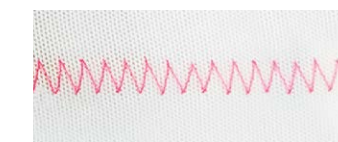

Stitching Pattern Changeover Function

Equipped with two different functions, the machine is available to handle a wider range of application

LZ-2284B (Standard/3-step Zigzag) and LZ-2287B (3-step Zigzag/Scallop) can perform two stitching patterns by one machine, thereby increasing the machine operation rate.

Standard/3-step Zigzag Stitching Pattern Changeover Function

High-speed, 1-needle, Lockstitch, Zigzag Stitching Machine

LZ-2284B-7



Standard zigzag stitching



3-step zigzag stitching



Switch between the standard zigzag stitching pattern and 3-step zigzag stitching pattern with simple one-touch control

The operator can easily switch the needle-throwing pattern between the standard and 3-step zigzag stitching patterns using the lever located in the free space under the arm. When changing the sewing product or design, there's no need to adjust the sewing machine head or machine layout.



LZ-2284B7WBAK

LZ-2284B



LZ-2284B0B

3-step zigzag stitching Standard zigzag stitching



Standard/3-step zigzag stitching pattern changeover lever

Switch between the 3-step zigzag stitching pattern and scallop stitching pattern with simple one-touch control

High-speed, 1-needle, Lockstitch, Zigzag Stitching Machine

LZ-2287B



3-step zigzag stitching



Scallop stitching



3-step zigzag stitching and scallop stitching can be changed over through fingertip control

The mechanism for changing over the type of stitching between standard zigzag stitching and 3-step zigzag stitching has been well-received in the market. Now, the sewing machine which is able to change over the type of stitching between 3-step zigzag stitching and scallop stitching which are frequently used for sewing girdles has been added to the LZ Series.



LZ-2287B0B

Options

Hook with non-rotational bobbin



The hook with non-rotational bobbin eliminates sewing troubles resulting from bobbin idling. It provides a uniform bobbin thread tension at all times, thereby guaranteeing a consistent stitch formation.

- 235-23152 Hook
- 235-22550 Bobbin case (asm.)
- 235-23004 Bobbin

Application	Mainly for the standard zigzag stitch: Effectively prevents the material swelling at the sewn part, as well as irregular stitches when sewing lace to slips, camisoles and shorts.
Precaution	The quantity of thread to be wound around this bobbin is approximately 60% of that wound around the conventional bobbin. Therefore, this bobbin is not recommended for pattern stitching such as three-point zigzag stitching and scallop stitching, or intape-attaching processes, even if the stitch system is the standard zigzag stitch.
Applicable thread	Thread specifically developed for sewing foundation garments and lingerie such as Resilon, Poelon, Satin, and Berlon (#50, #60)
Not-applicable thread	Thread which has naps, decorative yarn of multi-fiber thread such as woolly thread, Berlon D420 and D300, and spun thread

If you want to use a non-rotational bobbin, consult your distributor beforehand.

Oilless bobbin case / Hook (special race surface plastic hook)



The oilless bobbin case and hook effectively prevent oil stains.

*When using the oilless bobbin and hook, a hook driving shaft front setscrew (part number: 110-79506) is necessary.

- 235-57259 Hook compl. D
- 400-03609 Bobbin case D3 (compl.)
- 400-03610 Bobbin case D3 (asm.)

Hook gib



Soft seams can be produced by lowering the bobbin thread tension.

- 400-16408 Hook gib VS

Parts for sewing with thick thread [Set part number] 40231250 <recommended needle: DPx5 #21, 134SUK Nm130>



Knife unit
225-56054



Presser foot (asm.)
225-80369



Needle thread guide
D1440-583-H00



Thread tension disk (asm.)
400-17095

Pedal-operated reverse feed stitching device (RF-1)

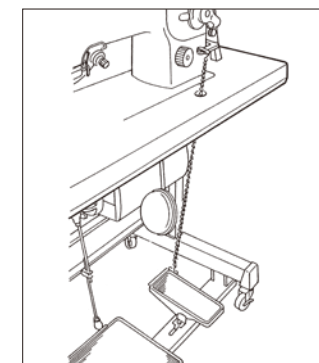

The device enables the operator to perform reverse feed stitching using the pedal without using the right hand.

GRF010000B0 (asm.)

Presser foot connecting components

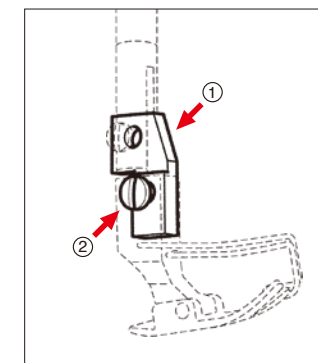

The aforementioned parts are used when a lockstitching type presser foot is installed on the machine. Select a parts set of either the presser-bar changing type or the presser bar joining type, according to the type of presser foot of your machine.

- Presser foot connecting components
- ① B1551-586-000 Presser foot connecting foot
 - ② SS-7090910-TP Screw

Other options

Part No.	Description	Feature
225-26578	Hook with a hard blade point	Prevents the blade point of the hook from wearing out
229-07406	Presser spring	This is the spring which strongly holds down the material when sewing a heavy weight material.
B3129012A00	Tension spring	Tightly tensed seams can be produced by increasing the tension applied to the needle thread.
40135178	Auxiliary Thread take-up Kit	Thread breakage and stitch skipping can be prevented by stabilizing the needle thread loops.
40273692	AK-161	This is an automatic presser foot lifter device for retrofitting.

List of the major gauges

Max. zigzag width / Max. feed pitch	Throat plate	Feed dog	Presser foot (with finger guard)	Remarks
	10041010 	10047017 	With a recess on the reverse side of the presser foot 22580369 	
	10041101 	22580104 	10045052 (finger guard: small) 	
	22580005 	22580500 	Light-in-weight type with the front fulcrum 22580765 	
	22582100 	22582209 	23503154 Light-in-weight type 	
	22582704 	22582803 	23503162 (finger guard: small) 	• Suited to sewing tasks that require frequent changes in the needle throw position.
	22582407 	22581508 	23503253 Front fulcrum type 	• Light-in-weight presser foot prevents jumping at the time of high-speed sewing.
	22582506 	22548804 	22580864 	
	22545008 	22540009 	10055051 (finger guard: small) 	
	22545511 	22540009 	22584965 Light-in-weight type 	
	22545107 	MAB109000B0 	22549604 Light-in-weight type 	
	22545362 Light-in-weight type 	22545867 		
	22545610 			

Max. zigzag width / Max. feed pitch	Throat plate	Feed dog	Presser foot (with finger guard)	Remarks
	22548705 	22548804 	22548960 Light-in-weight type 	
	22548507 	22548408 	22547962 Light-in-weight type 	• For standard zigzag stitching
	22548010 	22548119 	22547970 (finger guard: small) 	
	22549000 	22541601 	22547962 Light-in-weight type 	• The 5mm-feed is suited to tape-attaching process where the elastic tape is sewn with stretched.
	22549208 	22549109 	22548663 Light-in-weight type 	
	22546519 	22541809 	22548671 (finger guard: small) 	
	22546212 	22549307 	22547269 Light-in-weight type with the front fulcrum 	
	MAD04060000 	MAD04070000 	MAD040500A0 	• For attaching tape to brassieres, etc.
	22549604 	22549703 	22549869 Light-in-weight type 	

• In addition to the above-listed ones, many different gauges and attachments for zigzag stitching are available. Please contact us for details.