

## PS-800SB-2850

Pattern Seamer **Sewing area** 280mm(X) × 500mm(Y)

### Your Ingenuity creates opportunities for Automation

The machine head adopts the oilfree lubrication technology with supporting various sewing and materials



PS-800SB-2850ZKZV

Please watch the video clip



YouTube



Facebook

### Fabric Vacuum Function

Easy to set the sewing materials since Vacuum device work under the table. It is help to set softy/light fabric.

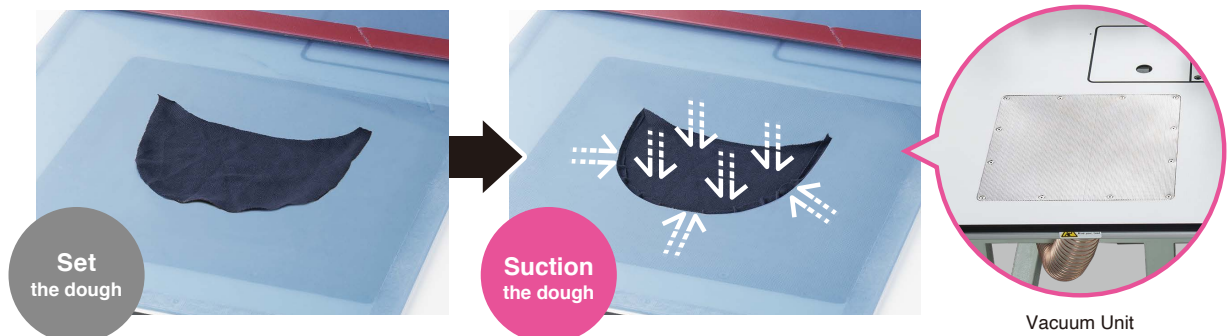

Set the dough

Suction the dough

Vacuum Unit

### Intelligent Medium-Presser Foot

It is possible to change the intermediate presser height at its lower dead point steplessly during sewing. This feature is particularly effective when sewing multi-layered portions of material. Since the material is stably held by the intermediate presser, sewing troubles such as stitch skipping and thread breakage are prevented.

#### Intermediate presser in general

Height of the intermediate presser is fixed at a certain height.

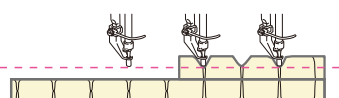

#### Programmable intermediate presser

The intermediate presser goes up/comes down in accordance with the material thickness.

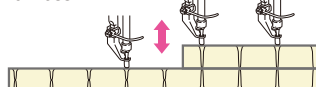

Pulse motor for intermediate presser



Plate presser foot

## Patterns are identified by means of RFID/Barcode reader to enable automatic reading of sewing data

Sewing patterns are automatically identified by means of RFID/Barcode reader to automatically call up the relevant sewing program, thereby starting sewing quickly.

### RFID (radio frequency identification)

It is the technology to read and write data saved on IC chips through wireless non-contact transfer of radio frequency waves and is used to identify and manage products.



RFID

## Operation panel

The sewing pattern data format are supports DXF, AI, PLT, and DST. Sewing pattern data in these formats are widely used in many sewing plants. As a result, the operation panel is able to use the customers' existing sewing pattern data immediately. As many as 999 sewing patterns can be saved on the large-capacity memory of the operation panel. (Editing software is included with the accessory.)



Panel

## Power switch

The power switch operates up and down, so the operator It can be adjusted to a position where it is easy to work. Reduces operator fatigue when sewing for long periods of time.



Power switch

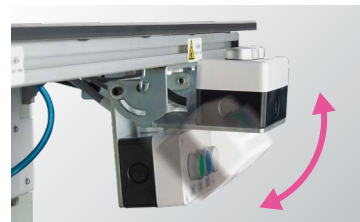

Power switch with variable mounting plate

## SPECIFICATIONS

Model name	PS-800SB-2850ZKZV PS-800SB-2850ZKWV	PS-800SB-2850ZKZ PS-800SB-2850ZKW
Sewing area	280mm × 500mm	
Max. sewing speed	3,500 sti/min*	
Lubrication	Semi-dry	
Fabric Vacuum Function	Standard	No (OP device can be retrofitted)
Hook	Full-rotary standard-capacity hook	
Lift / Stroke of intermediate presser	Lifting amount: 9 mm / Stroke: Standard 4 mm	
Thread trimmer	Double blades drive rotary knife type thread trimmer	
Template recogniser	RFID: 2850DKZ Barcode: 2850DKW	RFID: 2850ZKZ Barcode: 2850ZKW
JaNets device	Retrofittable	
Dimensions	1,060mm (W) × 1,330mm (L) × 1,250mm (H)	

\*sti/min is the abbreviation for "stitches per minute"

## WHEN YOU PLACE ORDERS

Please note when placing orders, that the model name should be written as follows:

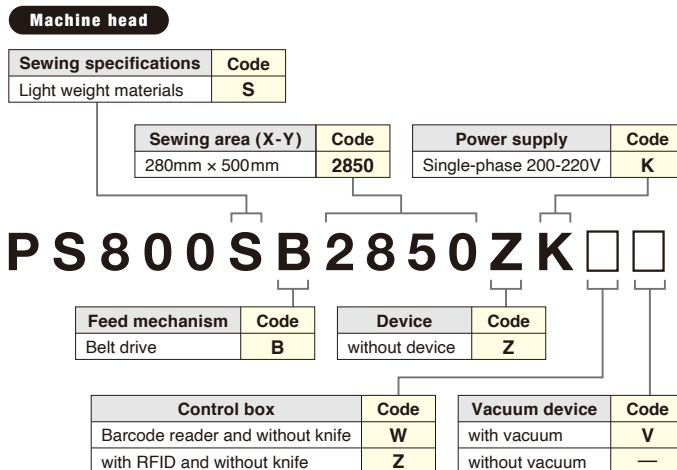

JUKI ECO PRODUCTS	The PS-800SB-2850 is an eco-friendly product which complies with JUKI ECO PRODUCTS standards for protecting the environment.
	<p>● The sewing machine complies with the "Juki Group Green Procurement Guidelines" on the use of hazardous substances, which is stricter than other restrictions, such as those of the RoHS Directive.</p> <p>For details of JUKI ECO PRODUCTS, refer to: <a href="https://www.juki.co.jp/en/company/eco">https://www.juki.co.jp/en/company/eco</a></p> <p><small>*The RoHS Directive is an EU Directive limiting the use of 6 hazardous substances (lead, hexavalent chromium, mercury, cadmium, PBB and PBDE) in electrical and electronic equipment. The Juki Green Procurement Guideline is the voluntarily established criteria to eliminate not only the aforementioned six substances, but also other ones which also adversely affect the environment.</small></p>



Registered Organization: JUKI CORPORATION Head Office  
The Scope of the Registration: The activities of research, development, design, sales, distribution, and maintenance services of industrial sewing machines, household sewing machines and industrial robots, etc., including sales and maintenance services of data entry systems.

**JUKI**  
JUKI CORPORATION  
SEWING MACHINERY & SYSTEMS BUSINESS UNIT

2-11-1, TSURUMAKI, TAMA-SHI,  
TOKYO 206-8551, JAPAN  
PHONE: (81) 42-357-2370  
FAX: (81) 42-357-2274  
<https://www.juki.co.jp/en>

\* Specifications and appearance are subject to change without prior notice for improvement.  
\* Read the instruction manual before putting the machine into service to ensure safety.  
\* This catalogue prints with environment-friendly soyink on recycle paper.  
\* Paper from responsible sources FSC™ C001712