



PS-800 Series
Pattern Seamer

- PS-800-13085Sewing area1,300mm(X) × 850mm(Y)
- PS-800-12080Sewing area1,200mm(X) × 800mm(Y)
- PS-800-8045Sewing area800mm(X) × 450mm(Y)

The dry head machine achieves max. speed 3,000sti/min
with supporting various sewing and materials.

Your Ingenuity creates opportunities for Automation

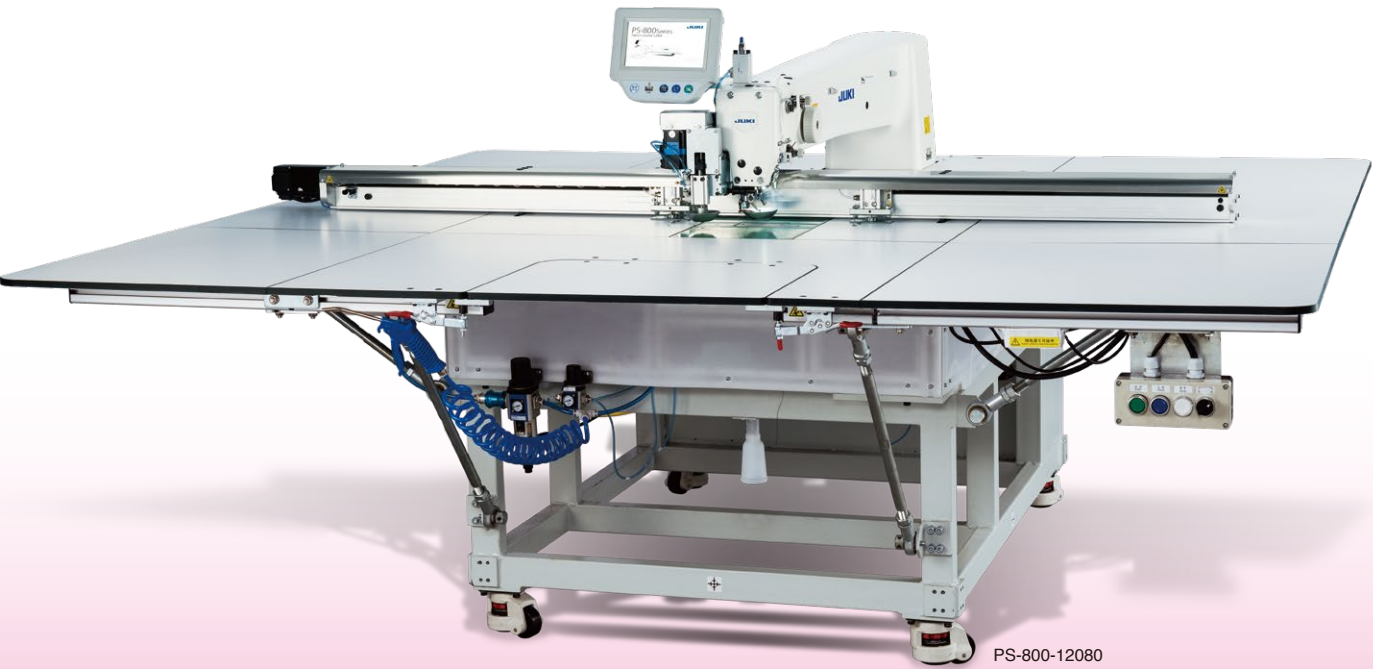

Pattern Seamer
PS-800 Series
PS-800-13085 • PS-800-12080 • PS-800-8045

Optional parts

Optional gauges (needle plate, intermediate presser), boat presser, table components, etc. are available.
Please contact your nearest JUKI distributor.

- **Needle plate** (Needle hole size: φ1.4, φ1.6, φ2.0, φ2.2, φ2.4, φ3.0, φ3.5 etc.)
- **Intermediate presser** (Needle hole size: φ2.2, φ2.7, φ3.5, φ4.0, φ2.0/φ4.5, φ2.5/φ9.6, φ2.5/φ11.5, φ3.8/φ4.5 etc.)

SPECIFICATIONS

Model name	PS-800SB13085	PS-800HB13085	PS-800SB8045	PS-800HB8045	PS-800SS12080	PS-800HS12080
Sewing area	1,300 mm × 850 mm		800 mm × 450 mm		1,200 mm × 800 mm	
Feeding type	Double stepping motor Belt Drive				Screw drive (ball screw)	
Max. sewing speed	3,000 sti/min*					
Stitch length	0.5 - 12.7 mm					
Hook	Full-rotary double-capacity hook					
Lift / Stroke of intermediate presser	Lifting amount: 20 mm / Stroke: Standard 4 mm					
Variable lower position of the intermediate presser	0 - 9 mm					
Needle	DB × 1 #8 (7#~14#)	DP×17 #21 (18#~23#)	DB × 1 #8 (7#~14#)	DP × 17 #21 (18#~23#)	DB × 1 #8 (7#~14#)	DP × 17 #21 (18#~23#)
Storage of pattern data in the memory	Max. 999 patterns (80,000 sti/pattern)					
Number of Indentifiable patterns	999 patterns					
Program input mode	USB					
File format	Convert DXF / AI / PLT / DST format to SLW format with editing softwear					
Weight	500Kg		450Kg		750Kg	
Dimensions	2,190mm (W) × 2,100mm (L) × 1,250mm (H)		1,200mm (W) × 1,325mm (L) × 1,250mm (H)		2,180mm (W) × 2,185mm (L) × 1,250mm (H)	

*sti/min is the abbreviation for "stitches per minute"

WHEN YOU PLACE ORDERS

Please note when placing orders, that the model name should be written as follows:

Machine head

Sewing specifications	Code	Applicable model	Feed mechanism	Code	Applicable model	Vacuum device	Code
Light weight materials	S	PS800 13085	Belt drive	B	PS800 8045・13085	with Vacuum device	V
Heavy weight materials	H	PS800 8045・12080・13085	Screw drive (ball screw)	S	PS800 12080	without Vacuum device	space

PS800

Sewing area (X-Y)	Code	Device	Code	Power supply	Code	Control box	Code
1,300mm × 850mm	13085	Rotary knife (upper and lower)	A	Single-phase 200-220V	K	with RFID and knife	K
1,200mm × 800mm	12080	Laser cutter	C	Single-phase 200-220V (CE)	N	Barcode reader and with knife	V
800mm × 450mm	8045	Non knife	Z			Barcode reader and without knife	W
						with RFID and without knife	Z

JUKI ECO PRODUCTS	The PS-800 Series is an eco-friendly product which complies with JUKI ECO PRODUCTS standards for protecting the environment.
	● The sewing machine complies with the "Juki Group Green Procurement Guidelines" on the use of hazardous substances, which is stricter than other restrictions, such as those of the RoHS Directive. For details of JUKI ECO PRODUCTS, refer to: https://www.juki.co.jp/en/company/eco <small>*The RoHS Directive is an EU Directive limiting the use of 6 hazardous substances (lead, hexavalent chromium, mercury, cadmium, PBB and PBDE) in electrical and electronic equipment. The Juki Green Procurement Guideline is the voluntarily established criteria to eliminate not only the aforementioned six substances, but also other ones which also adversely affect the environment.</small>

MS
CM001

EMS
ISO14001
JSAE389

Registered Organization: JUKI CORPORATION Head Office
The Scope of the Registration: The activities of research, development, design, sales, distribution, and maintenance services of industrial sewing machines, household sewing machines and industrial robots, etc., including sales and maintenance services of data entry systems.

JUKI JUKI CORPORATION
SEWING BUSINESS UNIT
2-11-1, TSURUMAKI, TAMA-SHI, TOKYO 206-8551, JAPAN
PHONE: (81) 42-357-2370 FAX: (81) 42-357-2274
<https://www.juki.co.jp/en>

- Specifications and appearance are subject to change without prior notice for improvement.
- Read the instruction manual before putting the machine into service to ensure safety.



The dry head machine achieves max. speed 3,000 sti/min with supporting various sewing and materials.

PS-800-13085 Sewing area 1,300mm(X)×850mm(Y)

PS-800-12080 Sewing area 1,200mm(X)×800mm(Y)

PS-800-8045 Sewing area 800mm(X)×450mm(Y)

Feeding type and sewing area

● Double stepping motor belt drive type



● Screw drive (ball screw) type

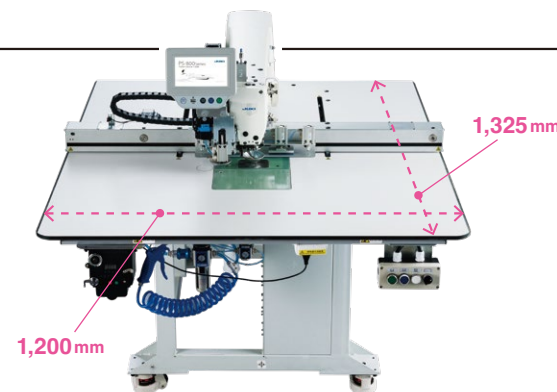

◆ Space-saving PS-800-8045

The PS-800-8045 can be installed in a space-saving manner. Not only the parts department but also sewing lines can be used. (The table size of PS-800-8045 width is 1,200mm width, the same as 1-needle lockstitch machine.)

Patterns are identified by means of RFID/Barcode reader to enable automatic reading of sewing data

Sewing patterns are automatically identified by means of RFID/Barcode reader to automatically call up the relevant sewing program, thereby starting sewing quickly.

*RFID (radio frequency identification): It is the technology to read and write data saved on IC chips through wireless non-contact transfer of radio frequency waves and is used to identify and manage products.

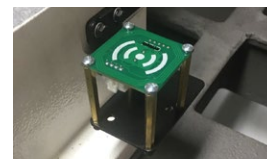

Oil stains are prevented

The machine head has adopted the advanced dry technology (no lubrication is required). Only the hook needs lubrication. The dry head is very effective when sewing materials on which oil stains are likely to spread such as those for down jackets.

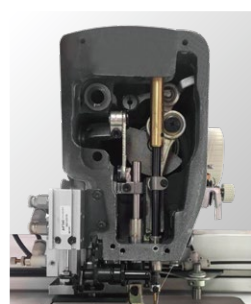

Cloth trimmer specifications

The cloth trimmer comes in two different knives and a laser.

● Rotary knife

This knife is suited to the sewing products designed to have straight portions and curve portions.



Rotary knife

● Laser cutter

This lazer is suited to soft materials such as knit.

Height of the intermediate presser at its lower dead point can be adjusted on the operation panel

It is possible to change the intermediate presser height at its lower dead point steplessly during sewing. This feature is particularly effective when sewing multi-layered portions of material. Since the material is stably held by the intermediate presser, sewing troubles such as stitch skipping and thread breakage are prevented.

Intermediate presser in general

Height of the intermediate presser is fixed at a certain height.

Programmable intermediate presser

The intermediate presser goes up/comes down in accordance with the material thickness.

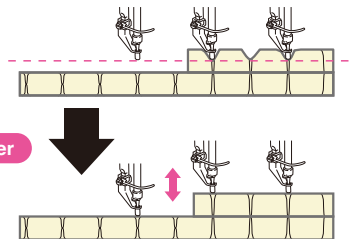

Operation panel

The sewing pattern data format are supports DXF, AI, PLT, and DST. Sewing pattern data in these formats are widely used in many sewing plants. As a result, the operation panel is able to use the customers' existing sewing pattern data immediately. As many as 999 sewing patterns can be saved on the large-capacity memory of the operation panel. (Editing software is included with the accessory.)



Optional device

Option	Parts No.	Features	Remarks
Bird nest prevention device	40228695	Stitching trouble called "bird's nest" phenomenon (needle thread tangles on the undersurface of the material to form a thread ball) is prevented by the needle thread hauling function.	Supported by all models ^{*1}
Third thread tension unit	40228696	This is the unit that is able to partially change the thread tension on a sewing pattern.	Only for the stitching category "S" (For H, this unit is provided as standard)
Active tension device	40228700	The needle thread tension can be electrically changed. Needle thread tension can be set easily on the operation panel on a stitch-by-stitch basis to allow not only setting of the needle thread that is interlocked with the material thickness but also as correction of the thread tension that is likely to vary according to the direction of sewing.	Supported by all models ^{*1, 2}
Lower thread detector device	40228698	The amount of thread remaining on a bobbin is detected with the sensor to allow the sewing machine to stop when the predetermined amount of thread is reached before the thread wound on a bobbin runs out. With this device, the operator is able to concentrate on sewing work without worrying about the remaining bobbin thread amount.	Supported by all models ^{*1}
BK-8: Bobbin changer device (Eight bobbins can be loaded)	8045..... 40246945 12080..... 40246947 13085..... 40246949 [all models...40228699] [Please refer to *3.]	Provided that a spare bobbin case which is loaded with a bobbin fully wound with thread is set before starting sewing, automatic replacement of bobbin cases is enabled to spare the operator the trouble of changing bobbin cases by hand, thereby increasing production efficiency.	Supported by all models, Air cylinder drive type ^{*1, 3}
Thick material kit	40228701	This is the gauge parts set for sewing heavy-weight materials.	Only for the stitching category "S" (For H, this unit is provided as standard)
Barcode reader unit	40235197	Sewing pattern that matches the template can be called up when the barcode on the template is read by the barcode reader.	For the electrical component category "V" and "W", this unit is provided as standard ^{*1}
Template lift cylinder asm.	40239772	This is the device that lifts and supports the template from under the table to allow the template to be inserted into the correct position.	Only for the PS-800-8045
Pen stick asm.	40228686	This is the device for writing a sewing reference mark on the material fabric with the pen by means of the XY feed mechanism.	Supported by all models

*1. You may need to upgrade the software to install the parts. Please contact your dealer for more information.

*2. Options may not be installed depending on the purchase time of PS-800. Please contact your dealer for more information.

*3. The part number changes depending on the purchase time of PS-800. Please contact your dealer for more information.