

Intelligent Storage Management *ISM Series*

JUKI

JUKISmart Solutions

Material receipt registration system

Incoming Material Station

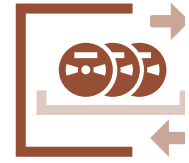

SOFTWARE



STORAGE



PRINTING



INSPECTION



PLACEMENT

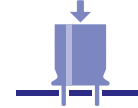

INSERTION



SOLDERING



INDUSTRY 4.0



TIME SAVING



NO MISTAKE



DDT CHECK



HOMOLOGATION CODE CHECK



AUTO-DETECT CODES 1D/2D



INTEGRATED WITH
ISM WAREHOUSES

Features

Incoming Material Station makes the work of receiving reel parts more efficient and reduces work mistakes.

In addition, it improves data registration and traceability while generating a new unique ID during warehousing work.

- You can set rules (code, letters, logo) individually for different label information for each supplier.
- The operator simply places the reel member on the stage, and the high-resolution camera reads the label information and prints the new label while generating a new unique ID.
- At the same time as printing the new label, you can output the storage information to your ERP or ISM server and save the imaging data for traceability.
- Work table: ESD compatible (resistivity 10 MΩ or less)
- You can share information with other systems (ERP, MES, mounter, etc.) through the API interface.
- Standard registration items (available fields) are part number, unique ID, case shape, quantity, PIN, date code, MSL, manufacturing PN, lot number, expiration date, supplier name, order reference, memo field, custom field.

Specification

	Incoming Material Station
Weight	101kg
Dimensions (WxDxH)	1,600×800×1,041mm
Power supply	Single-phase 100 ~ 240V
Power consumption	Max. 5A
OS	Microsoft Win10
Hardware	Table (ESD top plate)
	PC, Liquid crystal display
	Keyboard, Mouse, Speaker
	20Mpx camera (black and white)
	Wired 1D/2D code reader
	Label printer (option)
Software	Console software
	HALCON image processing library
	Auto-Incoming software
	Picture traceability
Software option	Qualified parts check function
	Delivery notes matching function



Configuration image

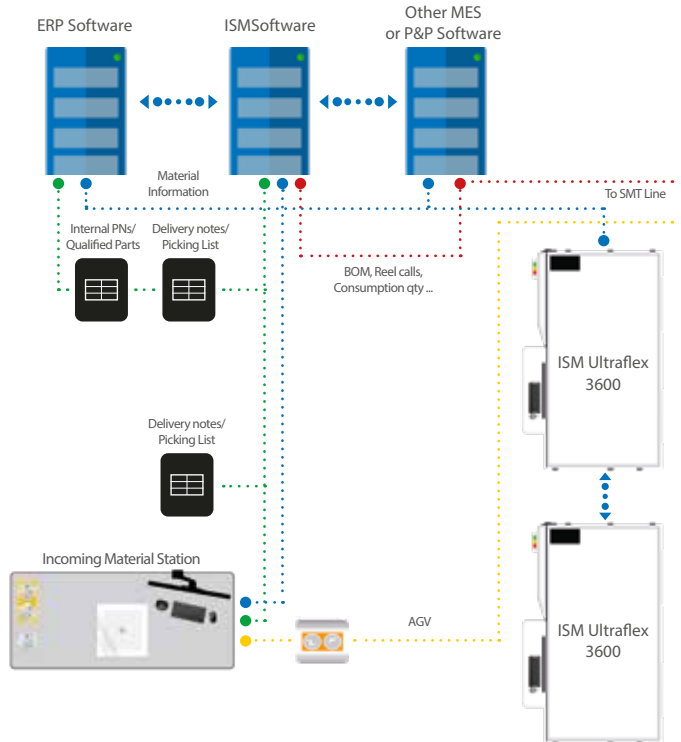

*Please refer to the product specifications for details.

■JUKI Specifications and appearance may be changed without notice.



JUKI CORPORATION HEAD OFFICE
The activities of research, development, design, sales, distribution, and maintenance services of industrial sewing machines, household sewing machines and industrial robots, etc., including sales and maintenance services of data entry systems.

MANUFACTURER : ESSEGI AUTOMATION S.r.l

INQUIRY : JUKI AUTOMATION SYSTEMS CORPORATION

2-11-1, Tsurumaki, Tama-shi, Tokyo 206-8551, JAPAN
TEL.81-42-357-2293 FAX.81-42-357-2285

ESSEGI
AUTOMATION

JUKI
www.juki.co.jp